

# **The Drummer's Drum.**

**PARTS CATALOGUE**

 **SONOR<sup>®</sup>**

# Parallel Snare Action

Ⓐ			Ⓑ			Ⓒ	84801854	knurled screw	M 6 x 4l
①	74606579	eccenter axle complete	①	74606254	housing	3a	75705913	tension spring	7.2 dia.
1a	84301513	cap nut M6	1a	74607200	nylon guide	3b	84000313	rivet 7 dia.	
1b	75900000	guide sleeve	1b	74607154	base	3c	74606354	tuning block	
1c	75900100	plastic roll 6 dia.	1c	84100512	cylinder screw	④	80103353	slotted screw	M 6 x 20
②	74606474	axle 6 dia.	1d	84400212	lock washer 5.1 dia.	4a	84401412	disc V 6	
③	74607354	rod 8 x 8	1e	84500112	washer 5.3 dia.	⑤	84500951	washer	
			1f	74601972	bolt	5a	84300512	nut M6	
			②	74601772	connecting rod	5b	84301513	cap nut M6	
			2a	74601653	eccentric 22 dia.		74606159	parallel snare action, complete	
			2b	75700610	pull spring 5 dia.				
			2c	84900153	set ring 12 dia.				
			2d	84103212	cylinder screw				
					M 4 x 6				
			2e	84103312	cylinder screw				
					M 4 x 7				
			2f	84104512	slotted screw				
					M 4 x 12				

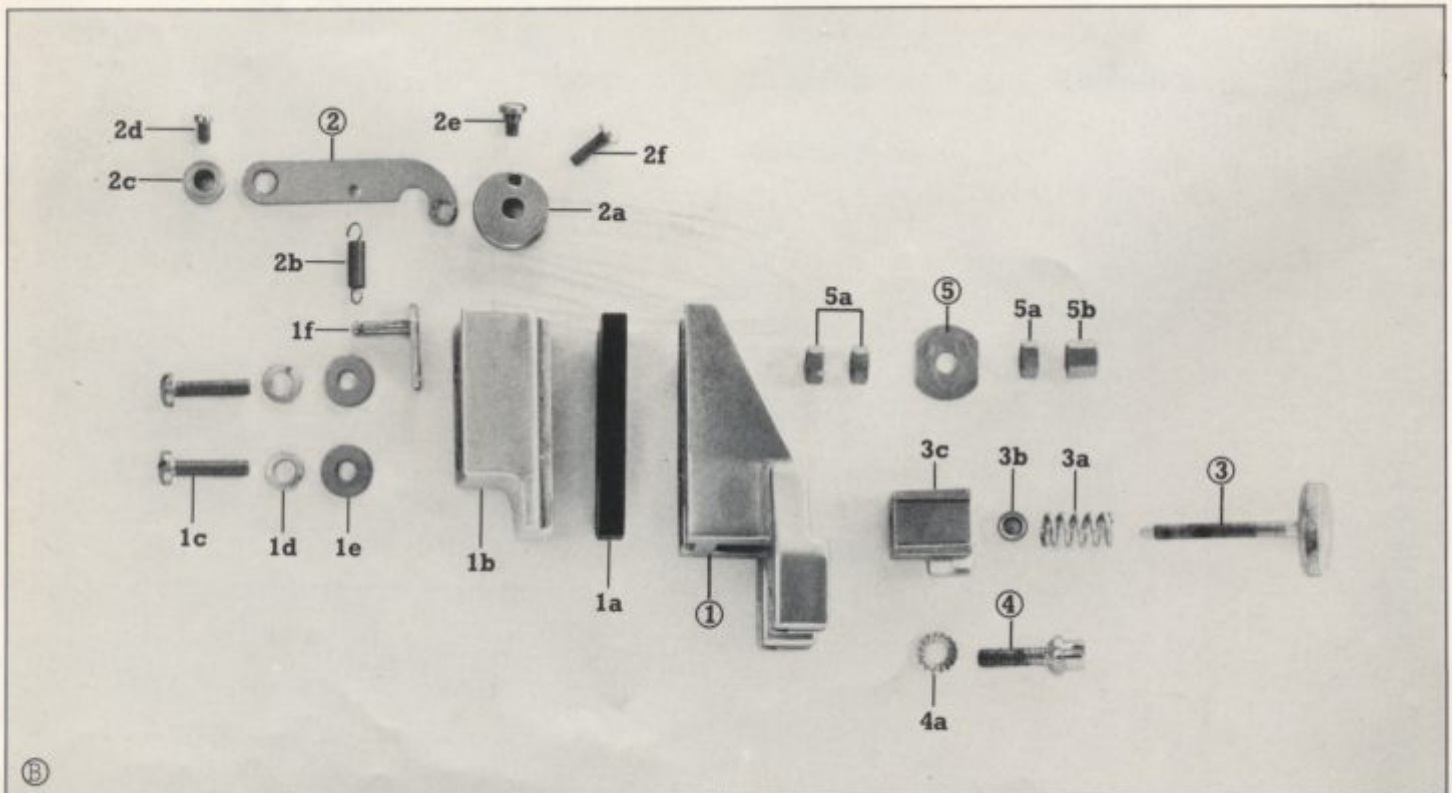
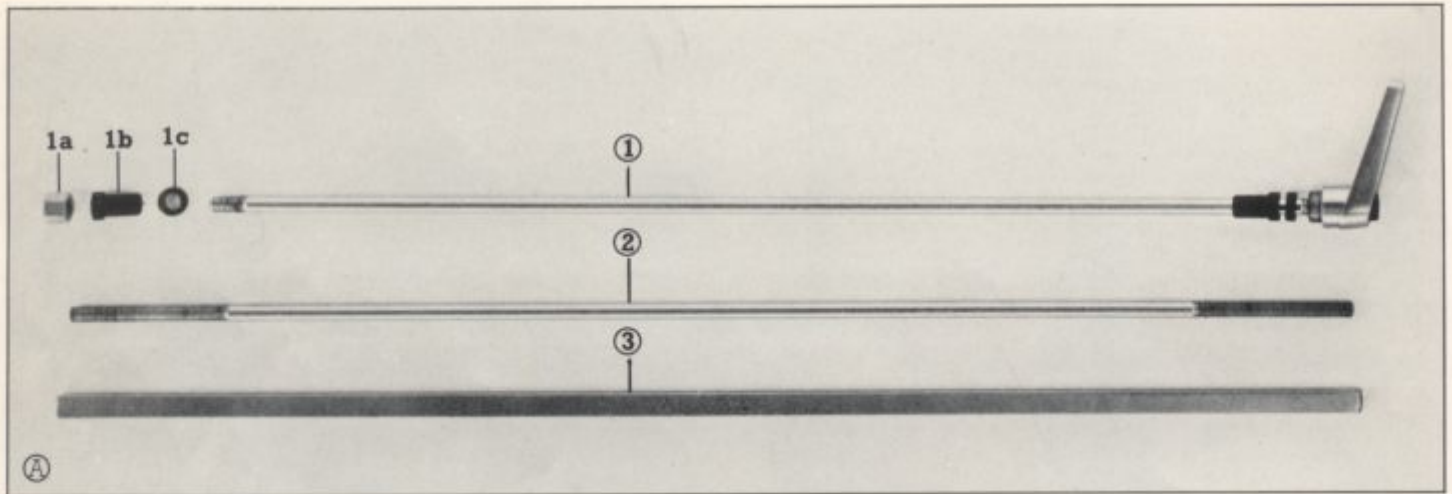

# Snares

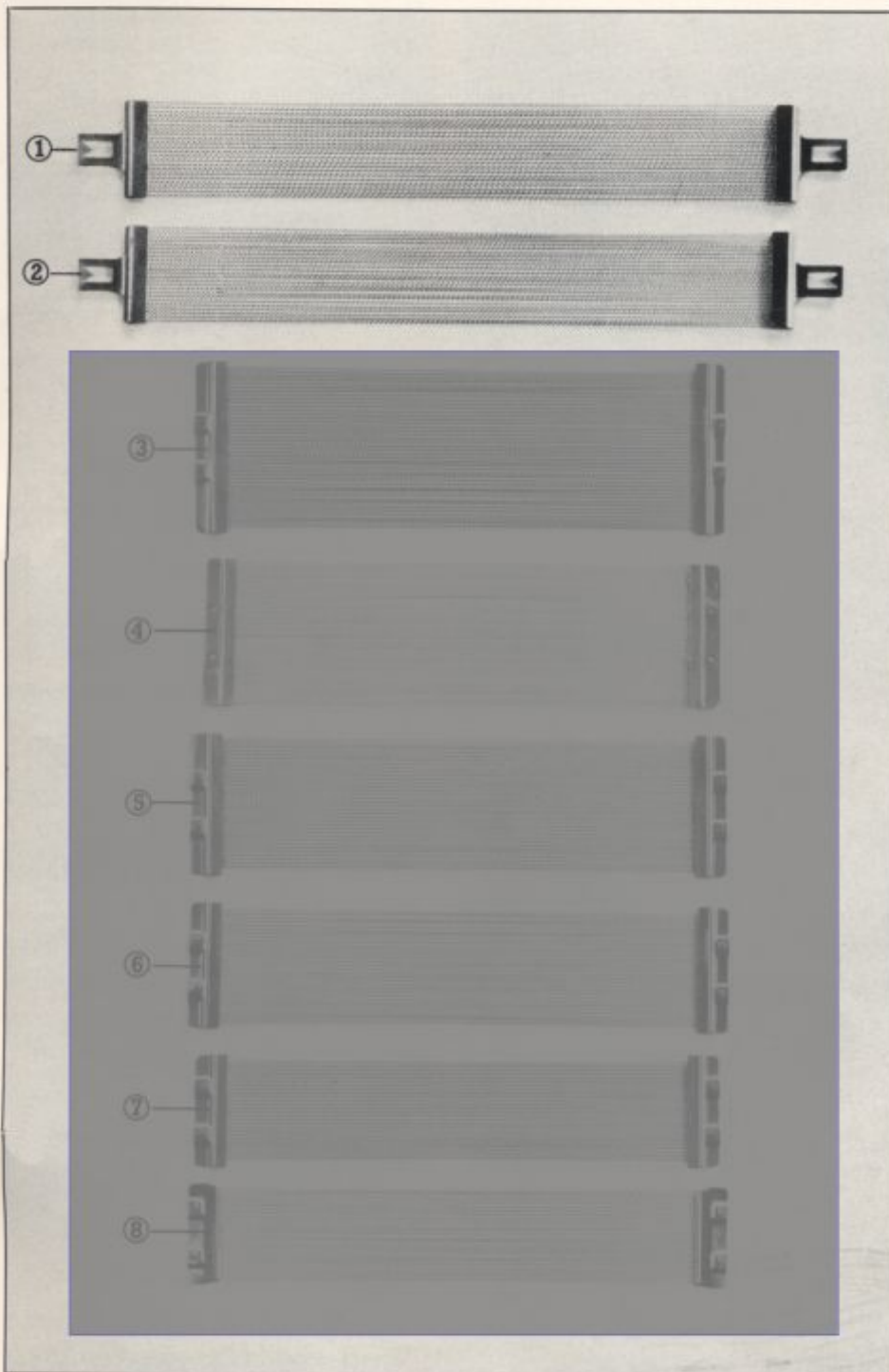

- ① 74705451 ROCK 22 strand heavy wire snares
- ② 74705251 JAZZ 24 strand thin wire snares
- ③ 74701851 42 strand wire snares
- ④ 74701751 38 strand wire snares
- ⑤ 74701651 34 strand wire snares
- ⑥ 74701551 30 strand wire snares
- ⑦ 74701451 26 strand wire snares
- ⑧ 74705151 24 strand wire snares

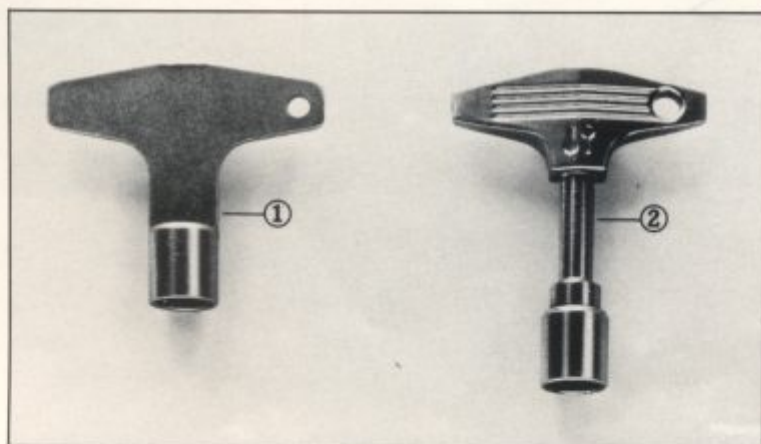

- ① 80501253 drum key
- ② 80500953 drum key

# Drum Lugs

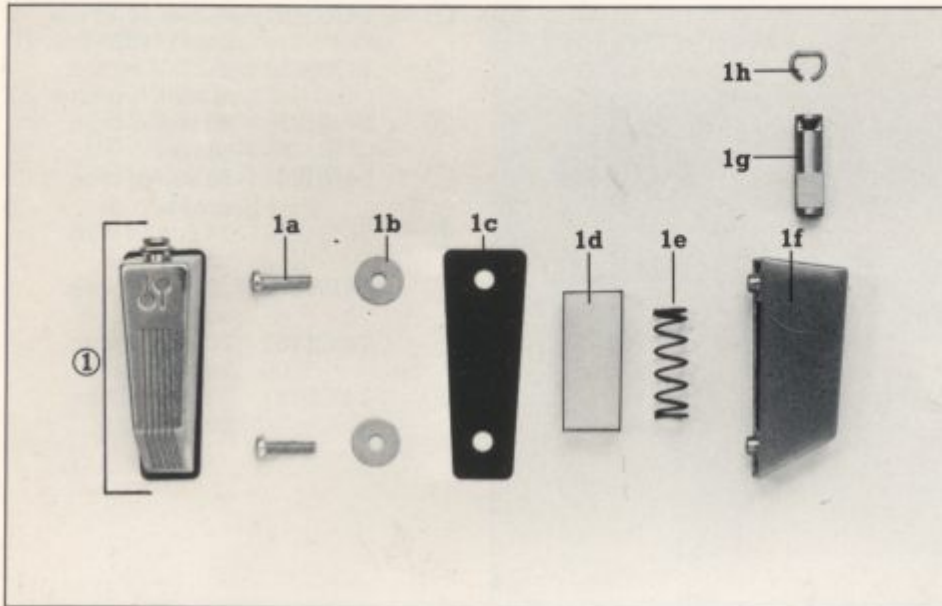

- ① 74104359 lug, complete
- 1a 84104612 slotted screw  
M 4 x15
- 1b 84503012 washer 4.3 dia.
- 1c 75901210 fibre rest
- 1d 74505010 foam lug insert
- 1e 75703510 tension spring  
10 dia.
- 1f 74102654 lug
- 1g 74506004 lug insert 1/4"
- 1h 74506113 snap-lock ring

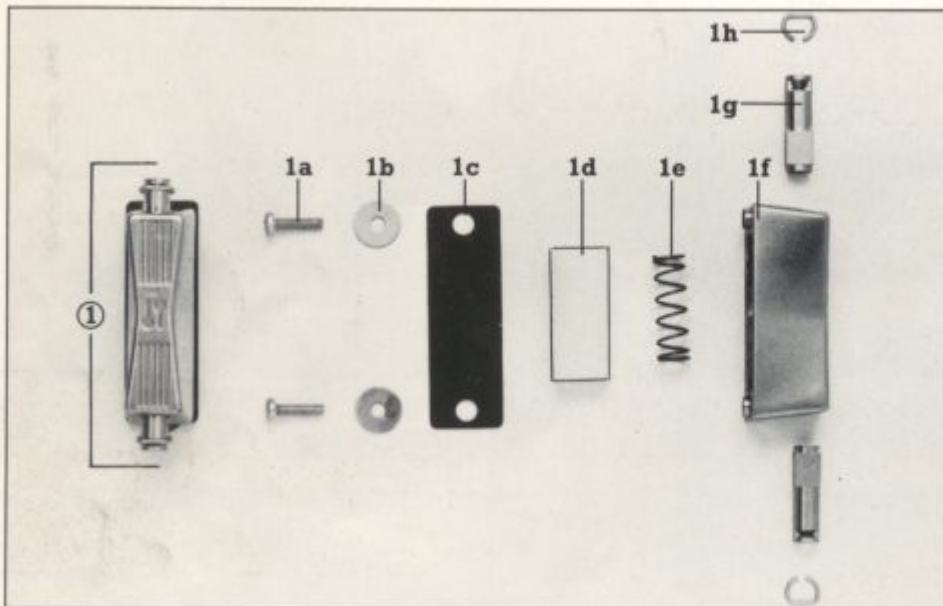

- ① 74105459 double lug,  
complete
- 1a 84104612 slotted screw  
M 4 x15
- 1b 84503012 washer 4.3 dia.
- 1c 75901600 fibre rest
- 1d 74505010 foam lug insert
- 1e 75703510 tension spring  
10 dia.
- 1f 74104154 lug
- 1g 74506004 lug insert 1/4"
- 1h 74506113 snap-lock ring

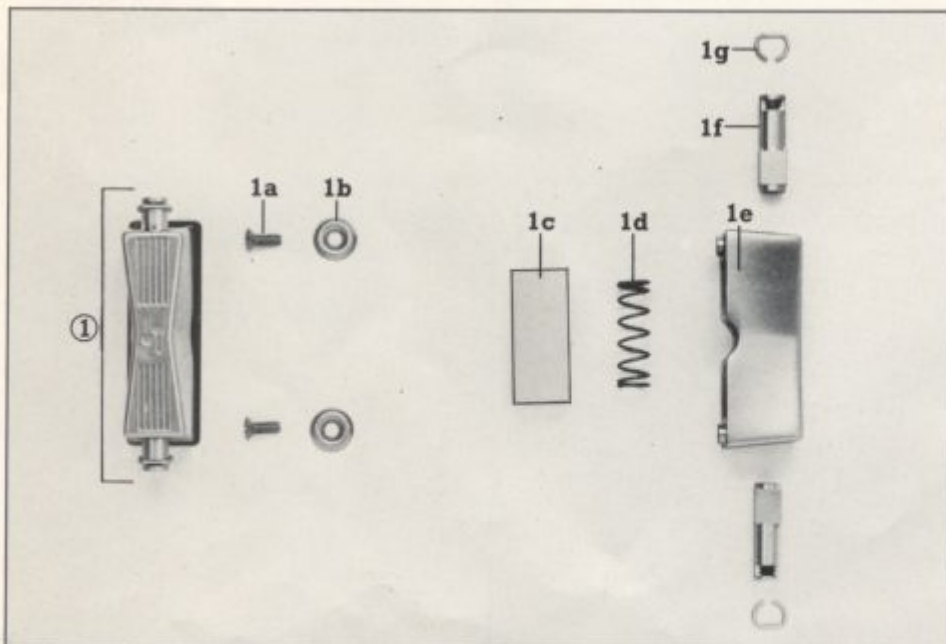

- ① 74104259 double lug  
complete
- 1a 84100912 screw M 4 x10
- 1b 84500212 washer
- 1c 74505010 foam lug insert
- 1d 75703510 tension spring  
10 dia.
- 1e 74102754 lug
- 1f 74506004 lug insert 1/4"
- 1g 74506113 snap-lock ring

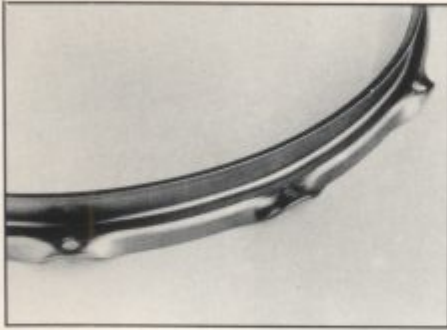

### Signature Series ferro manganese steel rims

- 72102774 6" rim, 4 rod
- 72102874 8" rim, 4 rod
- 72102974 10" rim, 5 rod
- 72100174 12" rim, 6 rod
- 72100274 13" rim, 6 rod
- 72100374 14" rim, 8 rod
- 72103074 15" rim, 8 rod
- 72100674 16" rim, 8 rod
- 72100774 18" rim, 9 rod
- 72103274 14" snare rim, top, 12 rod

### Phonic / Phonic Plus ferro manganese steel rims

- 72102773 6" rim, 4 rod
- 72102873 8" rim, 4 rod
- 72102973 10" rim, 5 rod
- 72100173 12" rim, 6 rod
- 72100273 13" rim, 6 rod
- 72100373 14" rim, 8 rod
- 72103073 15" rim, 8 rod
- 72100673 16" rim, 8 rod
- 72100773 18" rim, 9 rod
- 72103474 14" snare rim, top, 10 rod

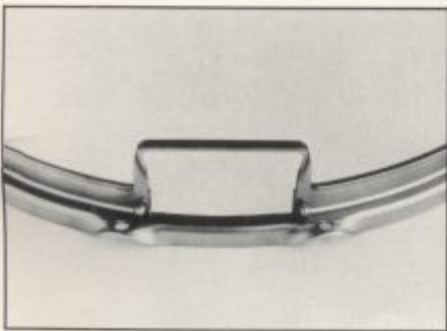

### Signature Series snare drum rim, bottom

- 72103379 14" snare rim, bottom, with snare guard, 12 rod

### Phonic / Phonic Plus snare drum rim, bottom

- 72102173 14" snare rim, bottom, with snare guard, 10 rod



### Signature Series heavy duty die cast rims

- 72103654 14" snare rim, top
- 72103759 14" snare rim, bottom with snare guard (not illustr.)



- 72103754 14" snare rim, bottom, without snare guard

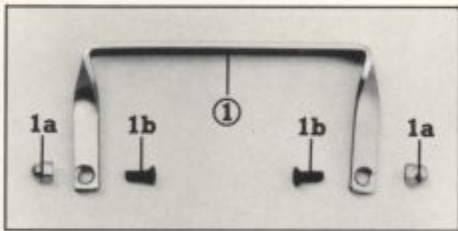

### Snare guard

- ① 74509374 snare guard for bottom rim
- 1a 84304713 cap nut M3
- 1b 84106010 screw M3x8



### Bass drum rims

#### Phonic / Phonic Plus bass drum rims

- 72102353 18" rim
- 72102453 20" rim
- 72102553 22" rim
- 72102653 24" rim

#### Signature Series bass drum rims

- 72102354 18" rim
- 72102454 20" rim
- 72102554 22" rim
- 72102654 24" rim



- 75802410 rubber anchor strip

# Bass Drum Spurs

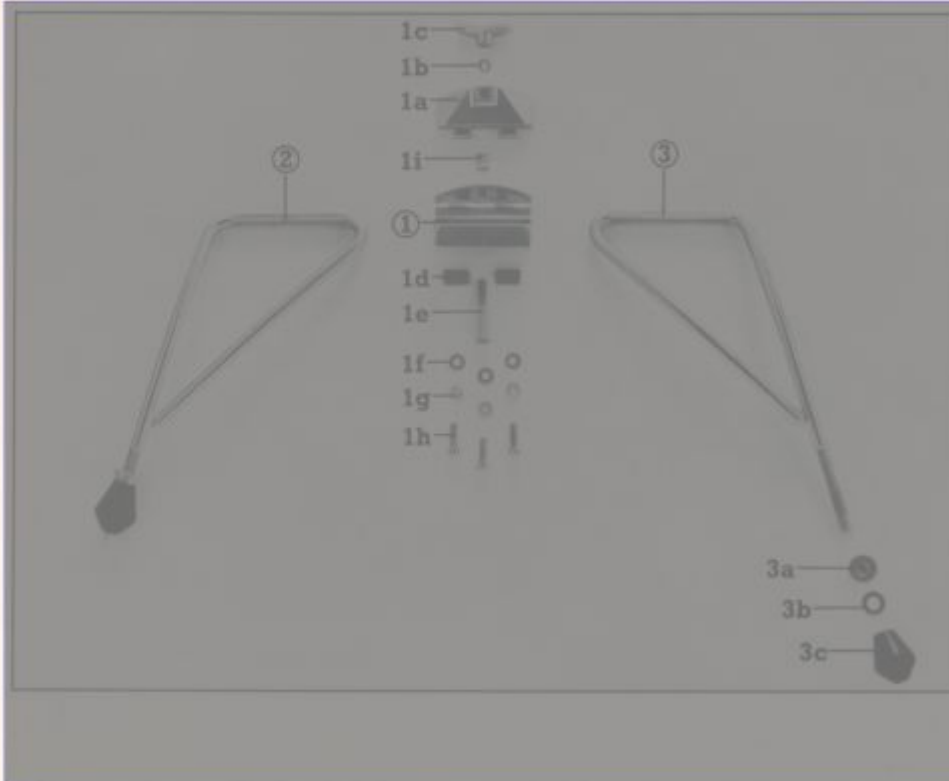

## Phonic

	11605501	Z 5060 right spur, complete, with prism clamp
	11605601	Z 5061 left spur, complete, with prism clamp
①	74105153	prism lug, bottom
1a	74105253	prism lug, top
1b	84500512	washer 6.5 dia./9x1
1c	80205253	wing nut M6
1d	74808372	spacer
1e	84207053	hex screw M6 x 45
1f	84502512	washer 6.6 dia.
1g	84400312	lock washer 6.1 dia.
1h	84200212	cylinder screw M6 x 25
1i	75702110	tension spring 9.75 dia.
②	74504479	spur, left, complete
③	74504579	spur, right, complete
3a	84304854	knurled nut M10 (until Feb. '82)
	84306359	knurled nut M10 (new from Feb. '82)
3b	84401110	washer 10.4 dia.
3c	75806900	rubber foot M10

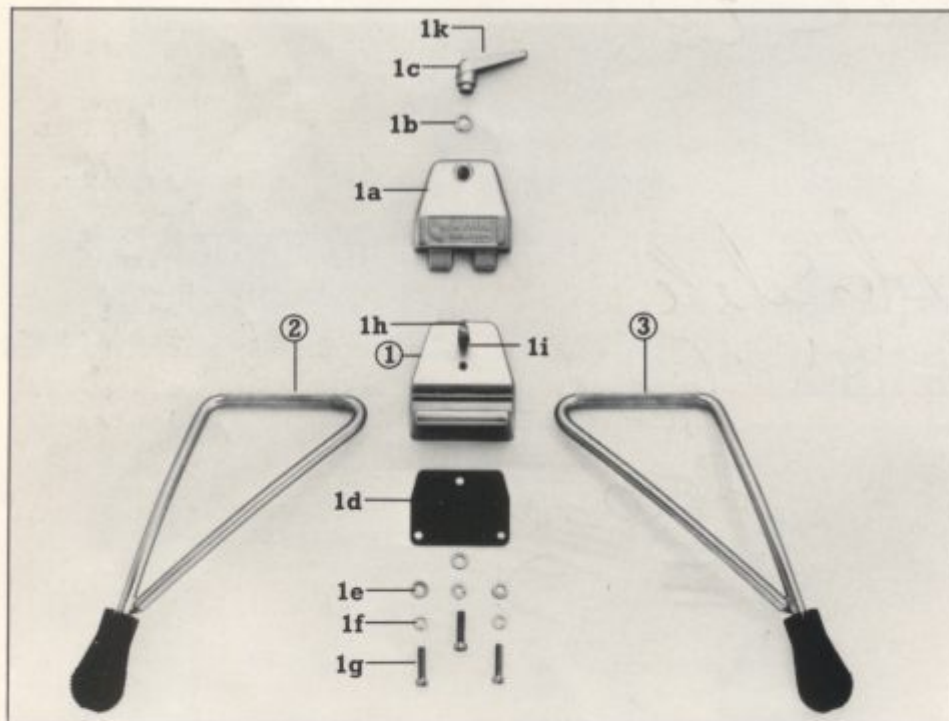

## Signature Series Spurs

	11605701	HLZ 5062 right spur, complete, with prism clamp
	11605801	HLZ 5063 left spur, complete, with prism clamp
①	74104954	prism clamping device, bottom
1a	74105054	prism clamping device, top
1b	84501112	washer 9.3 dia.
1c	80205154	lever nut M8
	80205159	lever nut with plug
1d	75901110	fibre rest
1e	84502512	washer 6.6 dia.
1f	84400312	lock washer 6.1 dia.
1g	84200212	cylinder screw M6 x 25
1h	84206212	cylinder screw M8 x 40
1i	84400412	lock washer 8.2 dia.
1k	75901010	plug
②	74507659	spur, left, complete
③	74507559	spur, right, complete

## Phonic Plus Spurs (not illustr.)

11606301	Z 5064 right spur, complete, with prism clamp	84400312	lock washer 6.1 dia.
11606401	Z 5065 left spur, complete, with prism clamp	84200212	cylinder screw M 6 x 25
74104953	prism clamping device, bottom	84206212	cylinder screw M 8 x 40
74105053	prism clamping device, top	84400412	lock washer 8.2 dia.
84501112	washer 9.3 dia.	74504479	left spur, complete
80206853	wing nut M8	74504579	right spur, complete
84502512	washer 6.1 dia.	84306353	knurled nut M 10
		84401110	washer 10.4 dia.
		75902100	rubber foot M10

# Floor Tom Legs

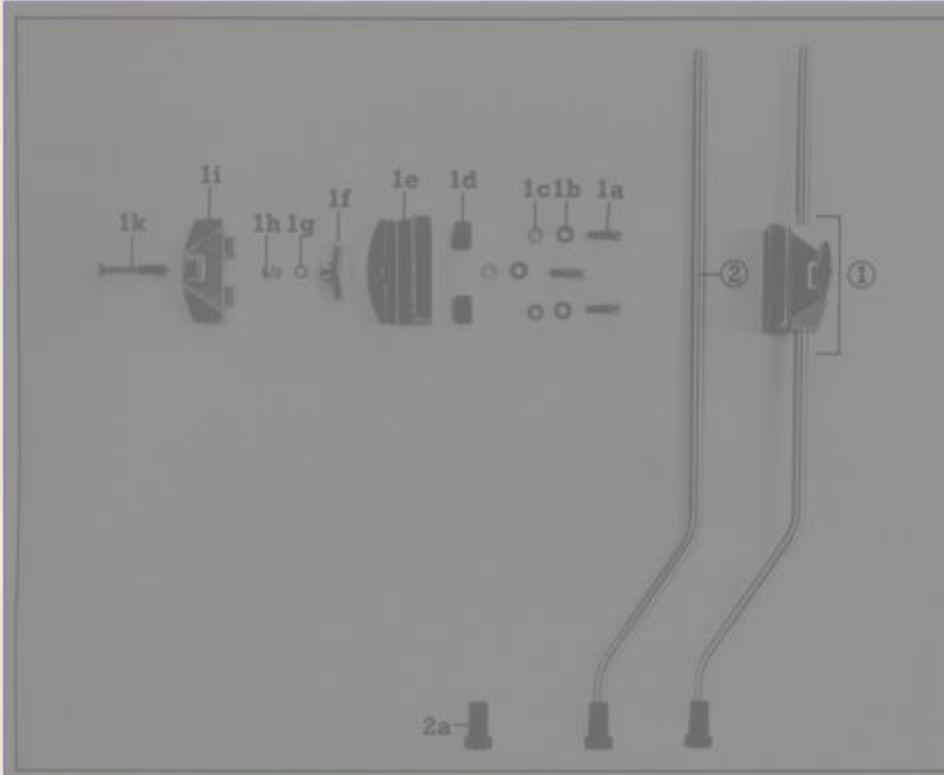

## Phonic/PhonicPlus Floor Tom Legs

①	74105159	prism lug, complete
1a	84200212	cylinder screw M6x25
1b	84502512	washer 6.6 dia.
1c	84400312	lock washer 6.1 dia.
1d	74508372	spacer
1e	74105153	prism lug, bottom
1f	80205253	wing nut M6
1g	84500512	washer 6.8 dia./9x1
1h	75702110	tension spring 9.75 dia.
1i	74105253	prism lug, top
1k	84207053	hex screw M6x45
②	74502179	leg, complete
2a	75804000	rubber foot

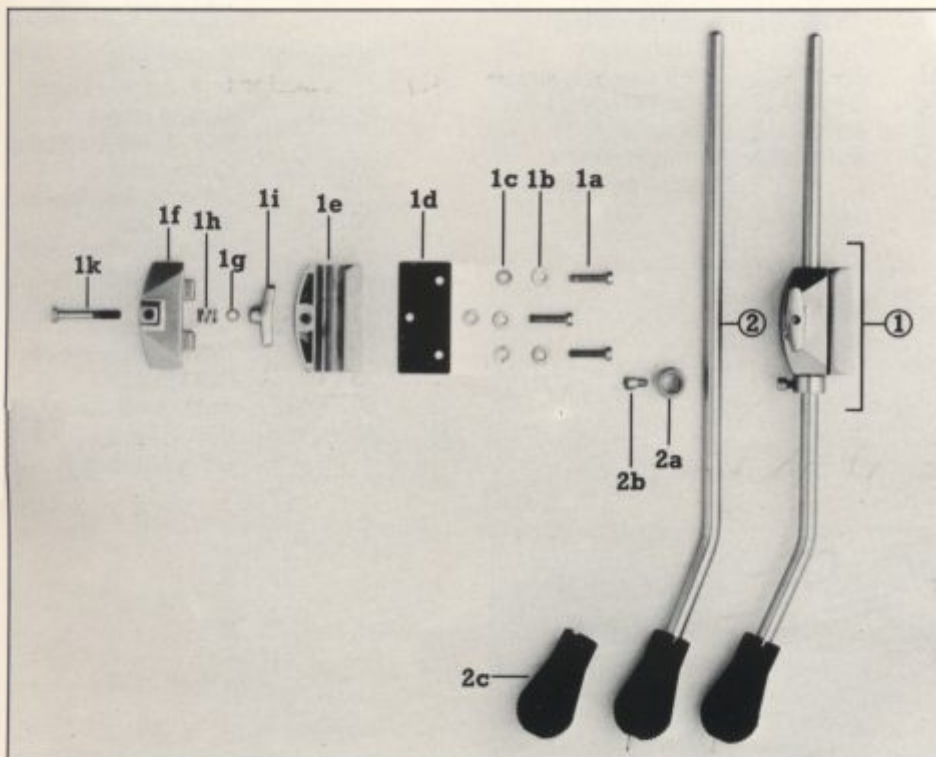

## Signature Series Floor Tom Legs

①	74105359	prism lug, complete
1a	84200212	cylinder screw M 6x25
1b	84502512	washer 6.6 dia.
1c	84400312	lock washer 6.1 dia.
1d	75901500	fibre rest
1e	74105154	prism lug, bottom
1f	74105254	prism lug, top
1g	84500512	washer 6.5 dia.
1h	75702110	tension spring 9.75 dia.
1i	80205254	wing nut M 6
1k	84207054	hex screw M 6 x 45
②	74507754	leg, complete
2a	74507854	ring 12.3 dia.
2b	80206354	slotted screw M 6x9
2c	75809600	rubber foot

# Drum Mounts, Screws

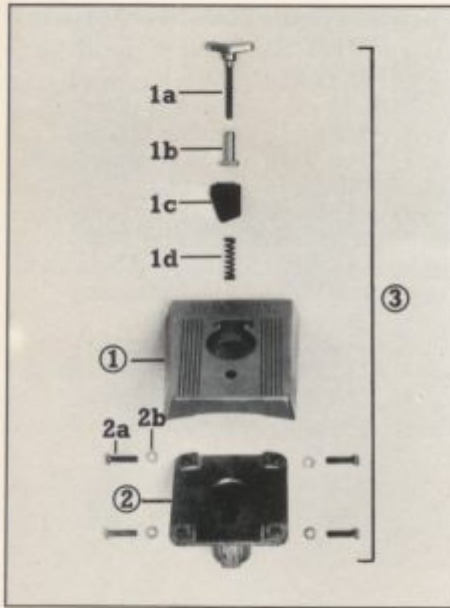

- ① 74103954 shell mount, top
- 1a 80205754 wing screw M 6 x 50
- 1b 74507054 threaded insert M 6 x 34
- 1c 75803200 wedge
- 1d 75704510 tension spring, 9.75 dia.
- ② 74103800 shell mount, bottom
- 2a 84200212 cylinder screw M 6 x 25
- 2b 84400312 lock washer 6.1 dia.
- ③ 11604001 bass drum mount, complete Z 5511a

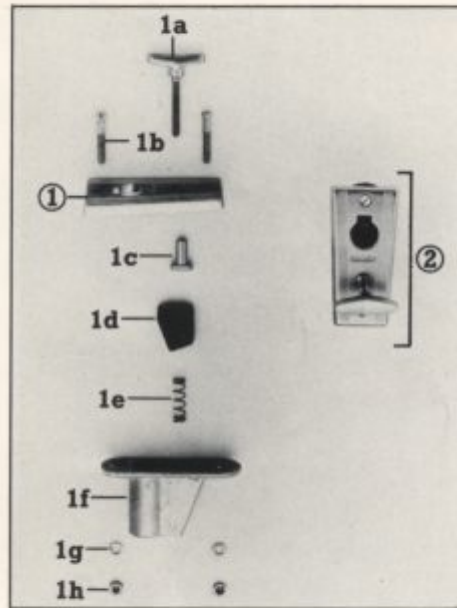

- ① 74104054 shell mount top plate
- 1a 80205954 wing screw M 6 x 45
- 1b 84203453 liko screw M 6 x 35
- 1c 74502854 threaded insert
- 1d 75803200 wedge
- 1e 75703510 tension spring 10 dia.
- 1f 74103051 shell mount housing
- 1g 84400312 lock washer 6.1 dia.
- 1h 84300512 hex nut M 6
- ② 11604201 tom tom mount, complete Z 5511c

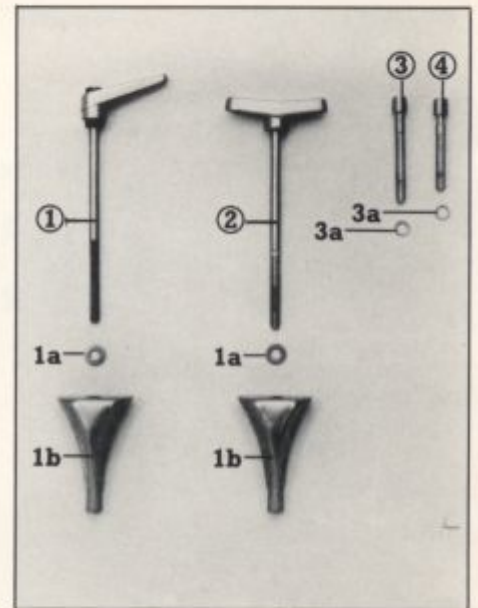

- ① 80102959 lever screw 1/4" x 120 (snap lock)
- 1a 84500412 washer 6.4 dia.
- 1b 74200154 claw hook
- ② 80102754 tension screw 1/4" x 120 (snap lock)
- 80100153 slotted screw 1/4" x 35 (not illustr.)
- 80100253 slotted screw 1/4" x 46 (not illustr.)
- 80100353 slotted screw 1/4" x 55 (not illustr.)
- 80102354 slotted screw 1/4" x 35 (snap lock)
- ③ 80102554 slotted screw 1/4" x 55 (snap lock)
- 80103153 slotted screw 1/4" x 70 (snap lock) (not illustr.)
- 3a 84500512 washer 6.5 dia.
- ④ 80102454 slotted screw 1/4" x 46 (snap lock)



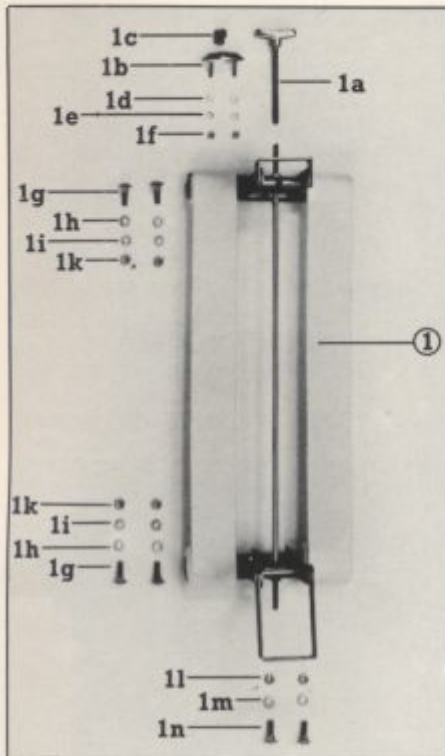

### Bass Drum Mufflers

- ① 11602001 muffler, complete for HLG 18 heavy, G3018 Z 5105
- 11602101 muffler, complete for HLG 20 heavy, G3020 Z 5106
- 11602201 muffler, complete for HLG 22 heavy, G3022 Z 5107
- 11602301 muffler, complete for HLG 24 heavy, G3024 Z 5108
- 11608001 muffler, complete for HLG 18 light Z 5115
- 11608101 muffler, complete for HLG 20 light Z 5116
- 11608201 muffler, complete for HLG 22 light Z 5117
- 11608301 muffler, complete for HLG 24 light Z 5118
- 1a 80103054 wing screw M6x80
- 1b 74800654 shell mount
- 1c 74802210 guiding bush
- 1d 84500312 washer 4.3 dia.
- 1e 84400112 lock washer 4.1 dia.
- 1f 84301112 hex nut M 4
- 1g 84200454 flat round screw M6x20
- 1h 84500412 washer 6.4 dia.
- 1i 84400312 lock washer 6.1 dia.
- 1k 84300512 hex nut M6
- 1l 84300412 nut M6
- 1m 84500912 washer 6.5 dia.
- 1n 84206054 flat round screw M6x20

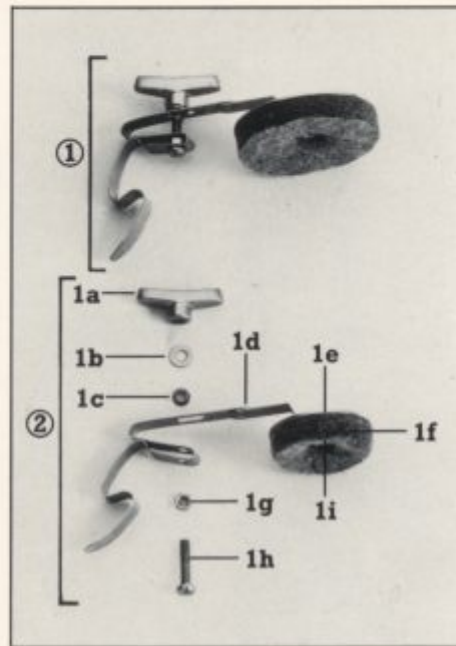

### External mufflers

- ① 11602701 external muffler Z 5112
- ② 11602601 external muffler Z 5111
- 1a 80205854 wing nut M 5
- 1b 84500112 washer 5.3 dia.
- 1c 84001012 rivet 6 dia.
- 1d 74802853 muffler spring band
- 1e 74802673 washer 50 dia. for Z 5111
- 74802773 washer 70 dia. for Z 5112
- 1f 74802500 felt washer 50 dia. for Z 5111
- 74800100 felt washer 70 dia. for Z 5112
- 1g 84300312 nut M 5
- 1h 84102412 cylinder screw M 5x25
- 1i 84501212 washer 5.2 dia.
- 1j 84000510 rivet 5 dia.

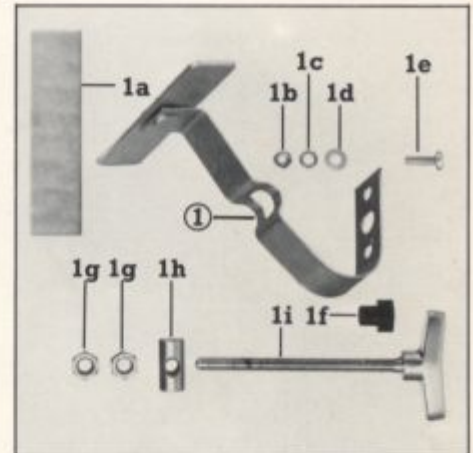
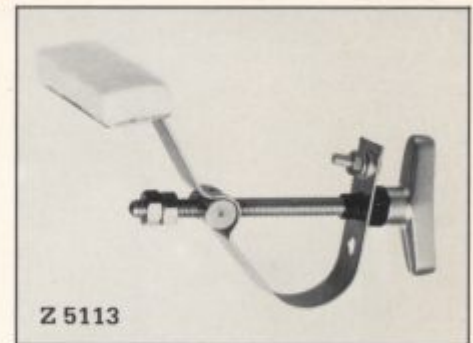

### Signature Series Internal Mufflers

- 11603501 internal muffler Z 5113, complete
- ① 74800559 bow spring
- 1a 74804010 felt washer
- 1b 84301112 nut M 4
- 1c 84400112 lock washer 4.1 dia.
- 1d 84500312 washer 4.3 dia.
- 1e 84104612 phillips screw M 4x15
- 1f 74802210 guide sleeve
- 1g 84300512 nut M 6
- 1h 74801452 roller
- 1i 80103054 wing screw M 6

### Internal Mufflers

- 11602501 internal muffler Z 5104, complete
- 11602410 internal muffler Z 5110, complete
- 74800500 bow spring
- 74800100 felt washer 70 dia. for Z 5104
- 74802500 felt washer 50 dia. for Z 5110
- 74800471 fibre washer 70 dia. for Z 5104
- 74800371 fibre washer 50 dia. for Z 5110
- 80103054 wing screw M6x80
- 74802210 guiding bush
- 84104612 slotted screw M4x15
- 84500312 washer 4.3 dia.
- 84400112 lock washer 4.1 dia.
- 84301112 nut M4
- 84300512 nut M6
- 74801452 roller with thread
- 84000510 rivet 5 dia. x 12



# Signature Series Bass Drum Pedal HLZ 5380

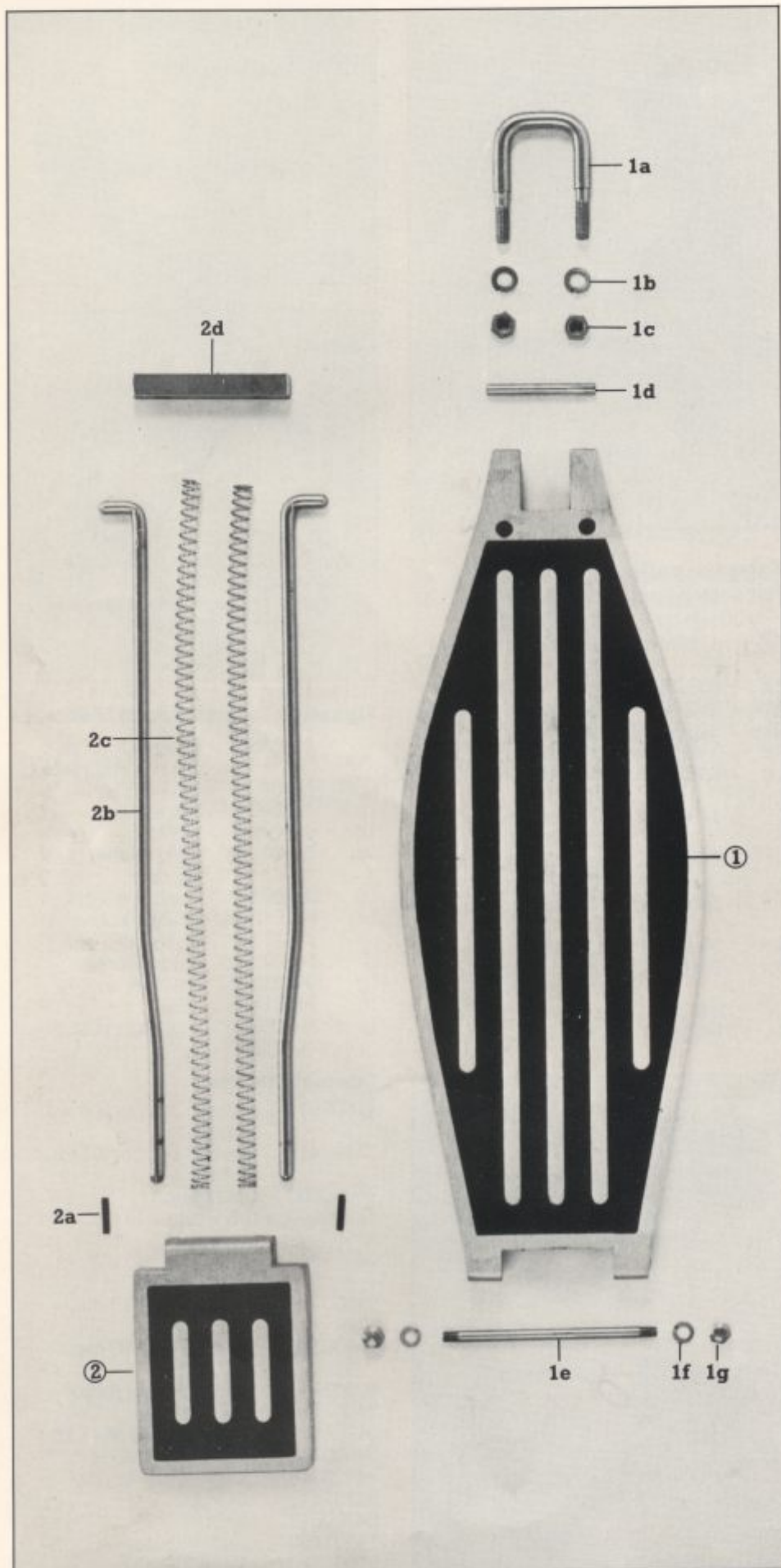

- ① 75306051 foot plate
- 1a 75406753 toe stop
- 1b 84400212 lock washer 5.1 dia.
- 1c 84300312 nut M5
- 1d 84703112 notched pin
- 1e 80201312 special screw M4 x 72
- 1f 84400112 lock washer 4.1 dia.
- 1g 84301713 cap nut M4
- ② 75306359 heel plate, compl. with struts
- 2a 84705010 notched pin 2 dia.
- 2b 75209474 strut 5 dia.
- 2c 75704810 tension spring 5.3 dia.
- 2d 75004274 lockbar for struts

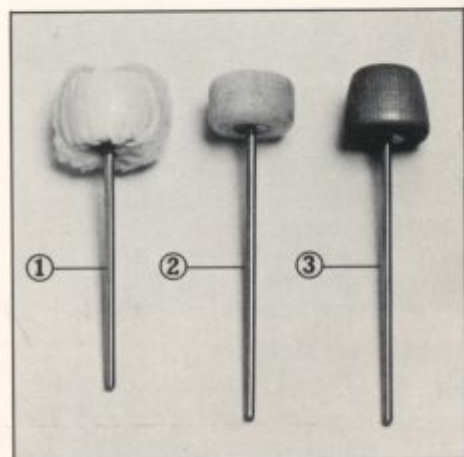

- ① 11605101 Sch 21 wool and leather beater
- ② 11605001 Sch 20 felt beater
- ③ 11605301 Sch 24 wood beater

# Signature Series Bass Drum Pedal HLZ 5380

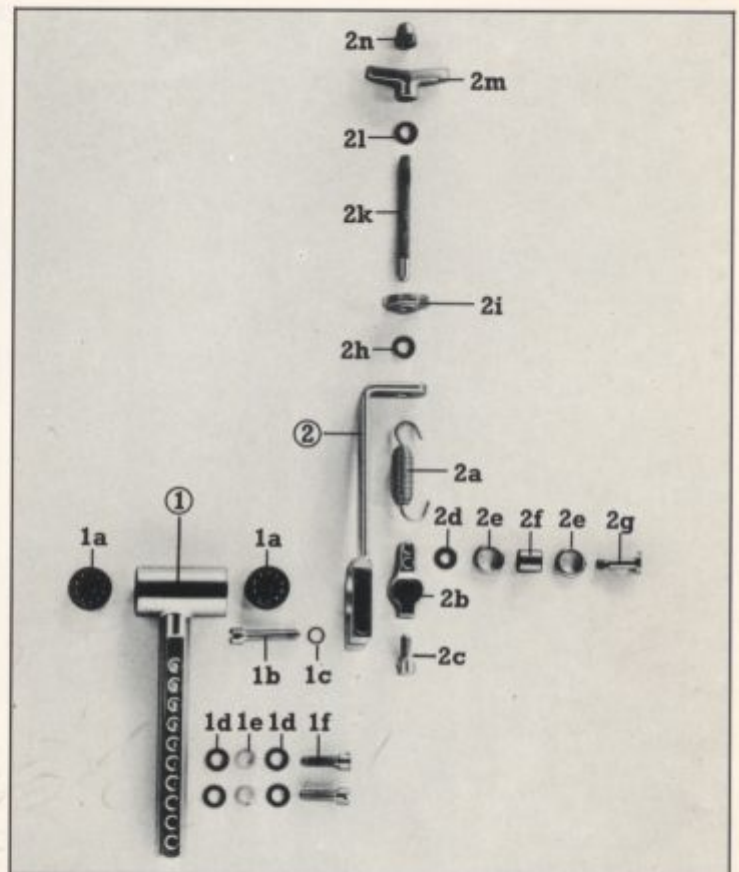
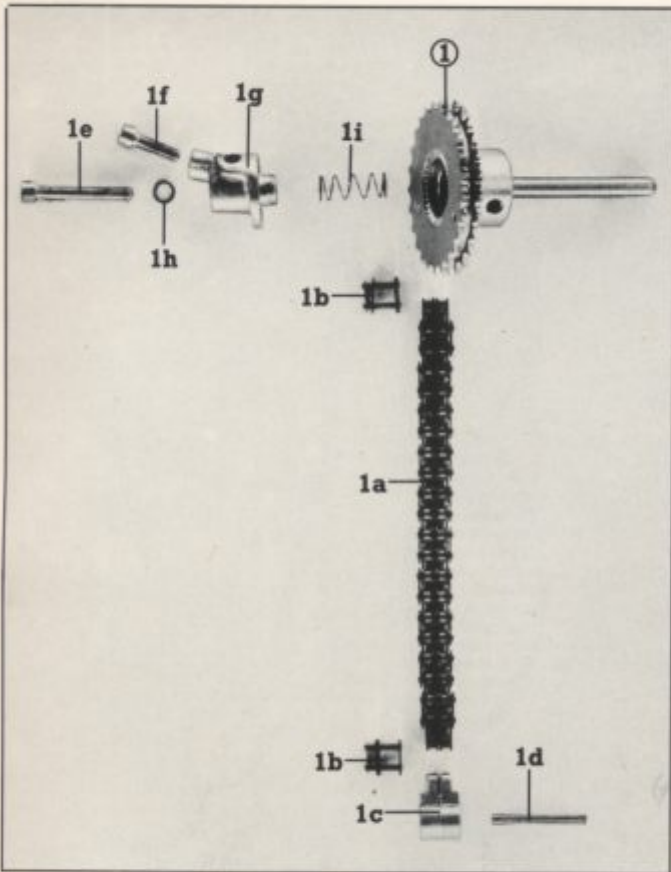

- |    |          |                        |    |          |                           |
|----|----------|------------------------|----|----------|---------------------------|
| ①  | 75005259 | sprocket with axle     | 1f | 80200353 | slotted screw<br>M6x20    |
| 1a | 75003400 | steel chain            | 1g | 75301251 | beater holder             |
| 1b | 75004100 | chain lock             | 1h | 84500512 | washer 6.5 dia.           |
| 1c | 75003554 | foot plate holder      | 1i | 75701012 | tension spring<br>10 dia. |
| 1d | 84703112 | notched pin 4 dia.     |    |          |                           |
| 1e | 80200453 | slotted screw<br>M6x40 |    |          |                           |

- |    |          |                         |
|----|----------|-------------------------|
| ①  | 75003774 | pillar                  |
| 1a | 84900800 | roller bearing 8 dia.   |
| 1b | 80203753 | slotted screw<br>M 6x30 |
| 1c | 84500512 | washer 6.5 dia.         |
| 1d | 84500412 | washer 6.4 dia.         |
| 1e | 84400312 | lock washer 6.1 dia.    |
| 1f | 80200353 | slotted screw<br>M 6x20 |

- |    |          |                         |
|----|----------|-------------------------|
| ②  | 75006174 | spring holder           |
| 2a | 75700412 | spring 11 dia.          |
| 2b | 75302454 | connecting rod          |
| 2c | 80200153 | slotted screw<br>M 6x15 |
| 2d | 84500112 | washer 5.3 dia.         |
| 2e | 75505853 | spacer 16 dia.          |
| 2f | 84900900 | roller bearing 6 dia.   |
| 2g | 84103713 | liko screw M 5x13       |
| 2h | 84500412 | washer 6.4 dia.         |
| 2i | 84303054 | knurled nut M 6         |
| 2k | 75503453 | tension bolt            |
| 2l | 84400810 | lock washer 6.5 dia.    |
| 2m | 80205254 | wing nut M 6            |
| 2n | 84301513 | cap nut M 6             |

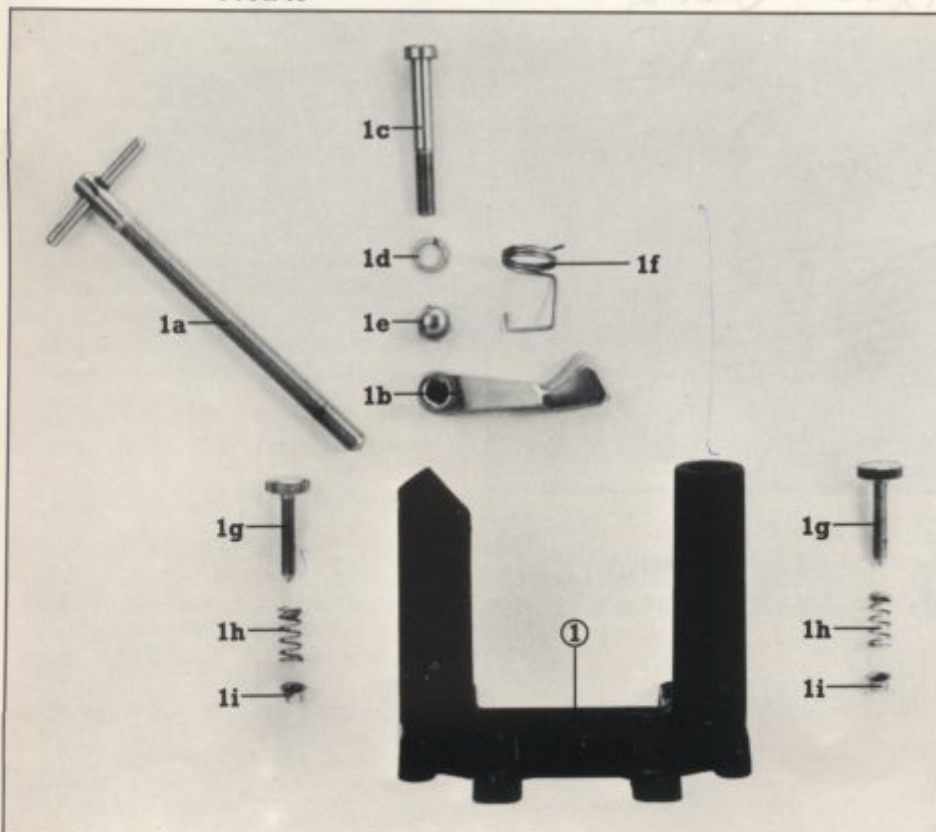

- |    |          |                            |
|----|----------|----------------------------|
| ①  | 75306559 | base                       |
| 1a | 80203053 | clamp screw                |
| 1b | 75304254 | clamp lever                |
| 1c | 84205913 | clamp lever screw<br>M8x60 |
| 1d | 84400412 | lock washer 8.2 dia.       |
| 1e | 84304913 | cap nut M8                 |
| 1f | 75703810 | clamp lever spring         |
| 1g | 84801254 | knurled screw<br>M6x30     |
| 1h | 75704112 | tension spring<br>7.2 dia. |
| 1i | 84000313 | rivet 7x0.4x5              |

# Signature Series Hi Hat Stand HLZ 5480

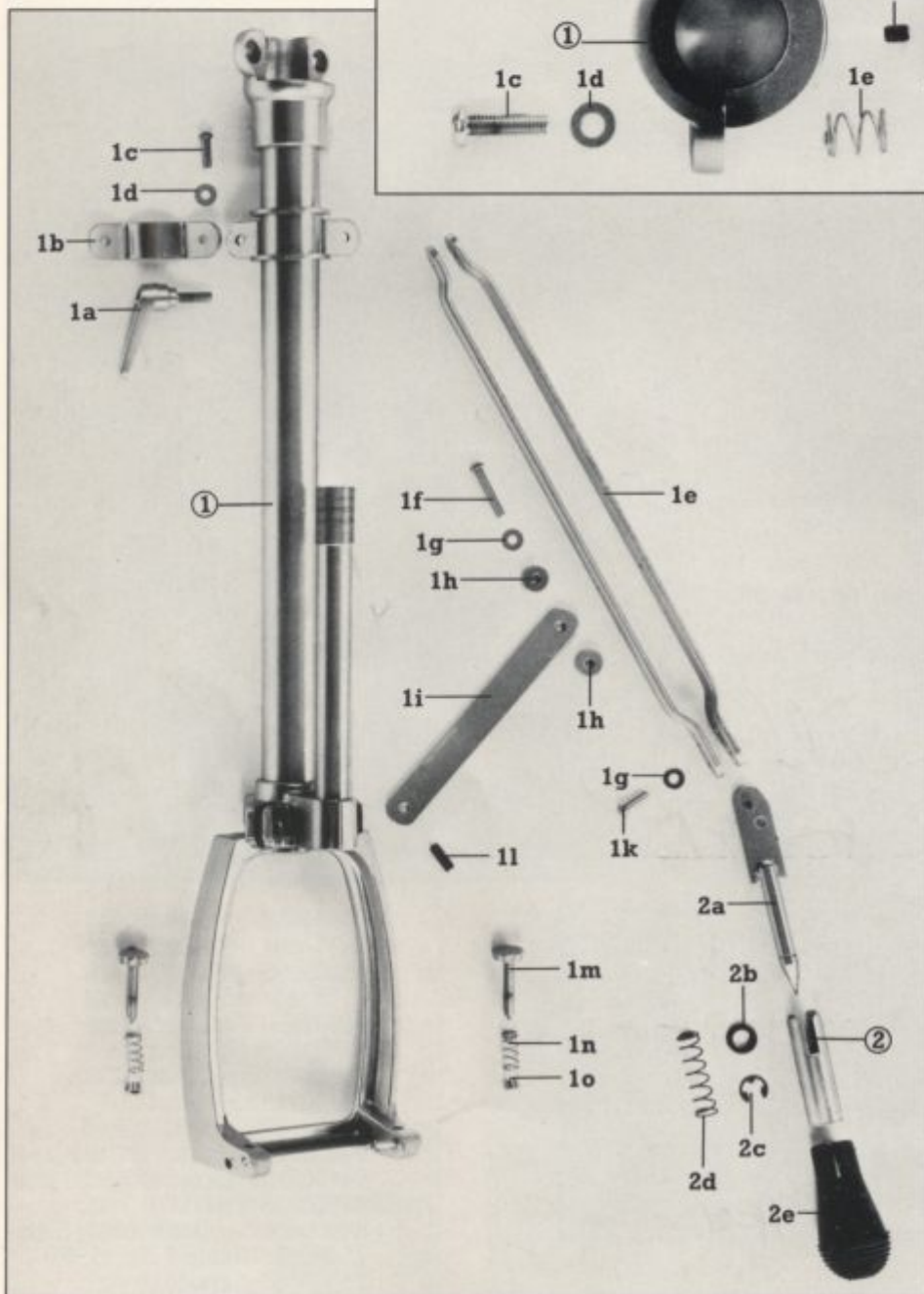

- ① 75000854 clamp 32 dia.
- 1a 84206713 cylinder screw M 8x30
- 1b 84400412 lock washer 8.2 dia.
- 1c 84206613 flat headed screw M 6x22
- 1d 84500412 washer 6.4 dia.
- 1e 75702210 tension spring 12 dia
- 1f 84003810 notched bolt 4 dia.x8
- 1g 75809300 clamp bushing 29 dia.
- 1h 75001054 bow 32 dia.
- 1i 84501112 washer 9.3 dia.
- 1k 80205154 lever nut M 8
- 1l 75901010 plug

- ① 75306459 base, complete
- 1a 80205554 lever screw M 6x20
- 1b 75208174 bracket without hole
- 1c 84002610 rivet 5 dia.x21.5
- 1d 84500112 washer 5.3 dia.
- 1e 75208974 long strut
- 1f 84002610 rivet 5 dia.x21.5
- 1g 84503112 washer 5.3 dia.
- 1h 84503213 spacer
- 1i 75209074 short strut
- 1k 84003510 rivet 5 dia.x 19.5
- 1l 84003312 notched pin
- 1m 84801254 knurled screw M6x35
- 1n 75704112 tension spring rivet 7 dia.
- 1o 84000313 tube
- ② 75509554 strut 20x5x55 with spur
- 2a 75208474 washer
- 2b 75809500 disc
- 2c 84503310 tension spring 10.5 dia.
- 2d 75704610 rivet 5 dia.
- 2e 84002810 rubber foot

# Signature Series Hi Hat Stand HLZ 5480

- ① 75003159 clutch, complete
- 1a 75003154 clutch housing
- 1b 84801454 knurled screw  
M10x1x22
- 1c 75801310 felt washer
- 1d 75502554 clutch stem
- 1e 75002800 clamping plate  
20x1.5
- 1f 75002904 clamp roll
- 1g 75702210 tension spring  
12 dia.
- 1h 75003000 see-thru disc

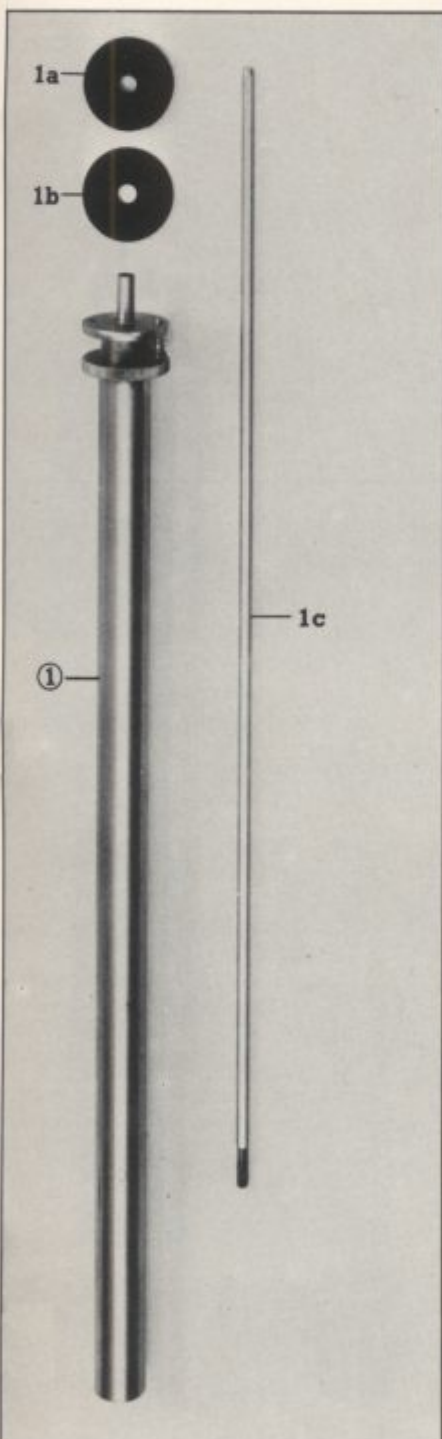
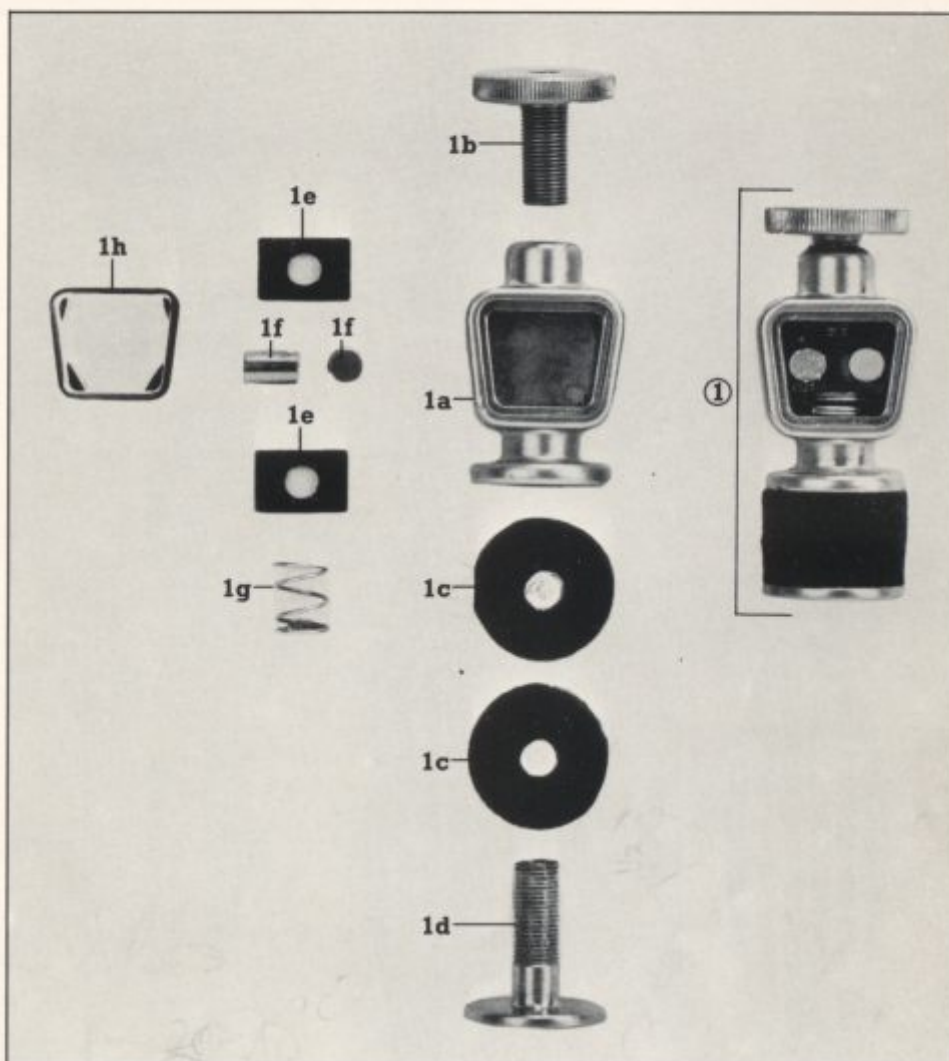

- ① 75002254 cymbal rest
- 1a 75002754 pin 4.8 dia.
- 1b 75702012 tension spring 6 dia.
- 1c 84501610 disc
- 1d 75901300 fibre washer  
13 dia.
- 1e 75002600 nylon bushing
- 1f 84305754 knurled nut
- 1g 75002554 thread M27

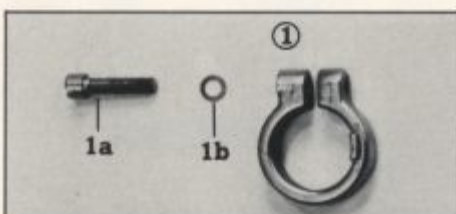

- ① 75001354 fix clamp 29 dia.
- 1a 80200253 slotted screw  
M6x25
- 1b 84500512 washer 6.5 dia.

- ① 75106759 top tube, complete
- 1a 75801500 felt washer 50 dia.
- 1b 75401971 fibre washer 50 dia.
- 1c 75209651 top rod

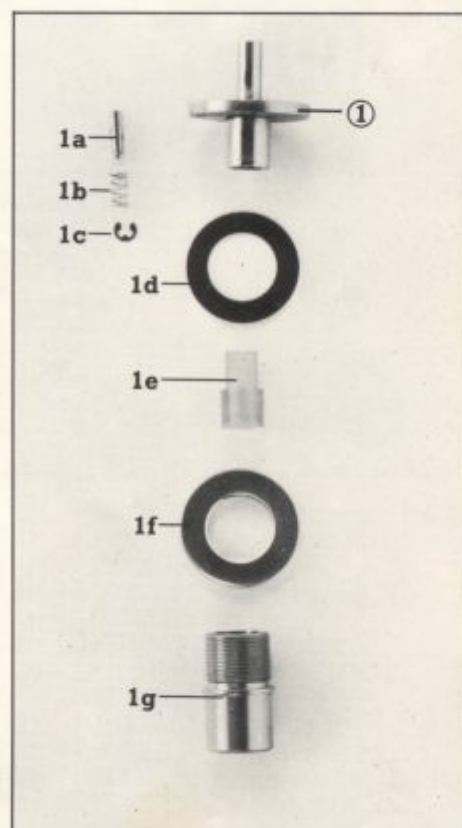

# Hi Hat Foot Plates

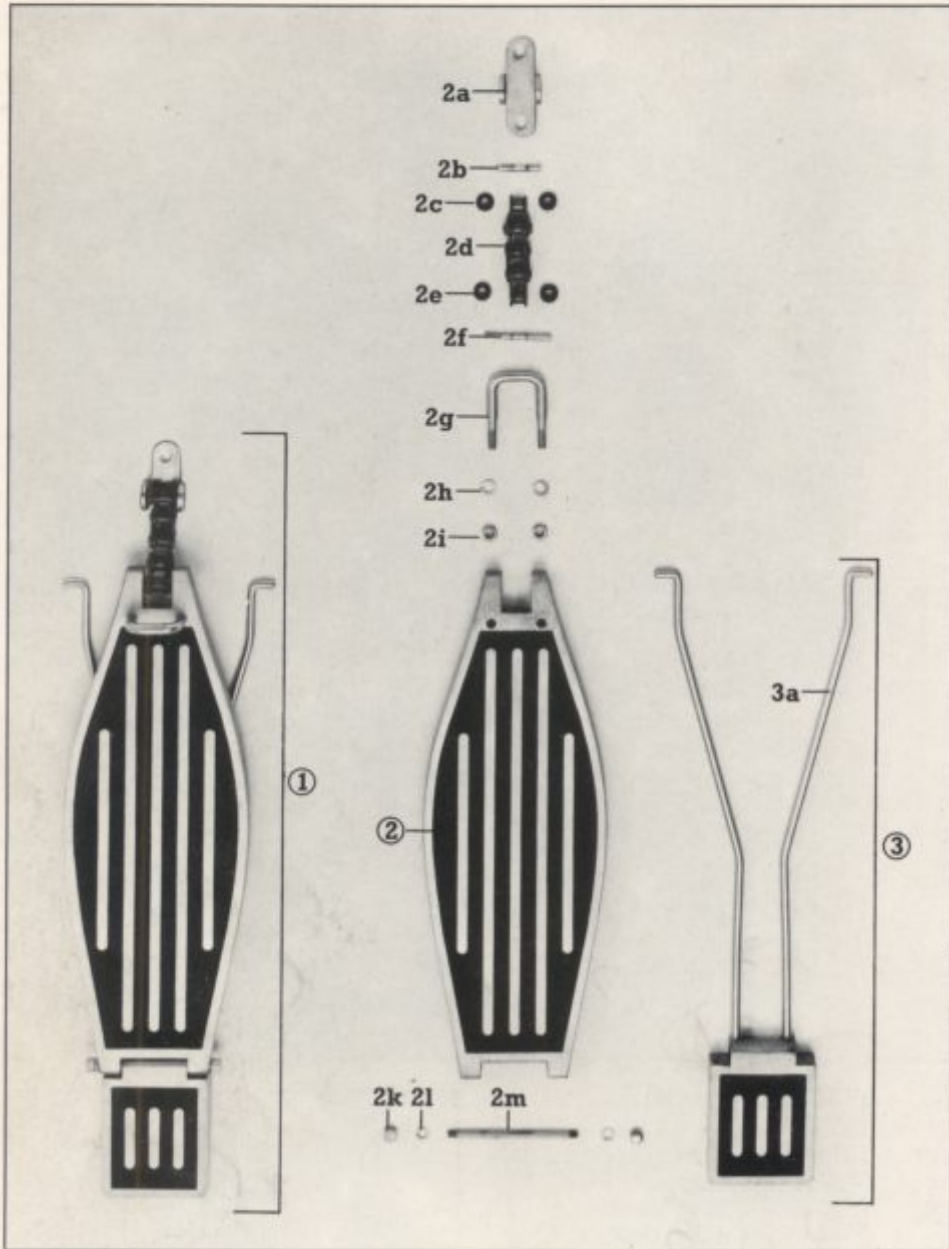

## Foot Plate for Signature Series Hi Hat Stand

①	75306059	foot plate complete
②	75306051	foot plate
2a	75407174	pull
2b	84702212	notched pin 4 dia.
2c	75900610	spacer 4.5 dia.
2d	75002059	steel chain, complete
2e	75900710	spacer 4.5 dia.
2f	84703112	notched pin 4 dia.
2g	75406753	toe stop
2h	84400212	lock washer 5.1 dia.
2i	84300312	nut M5
2k	84301713	cap nut M4
2l	84400112	lock washer 4.1 dia.
2m	80201312	screw M4 x 72
③	75306159	heel plate, complete
3a	75209774	strut for heel plate

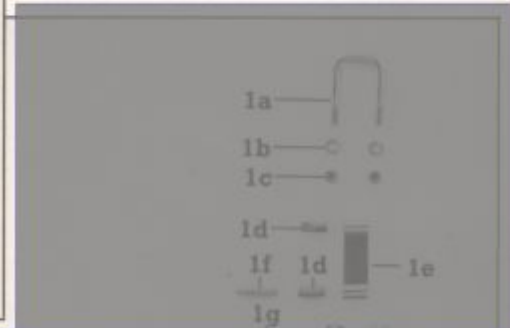

## Foot Plate for Phonic Plus Hi Hat Stand

①	75307151	foot plate
1a	75406753	toe stop
1b	84400212	lock washer 5.1 dia.
1c	84300312	hex nut M5
1d	75504110	bushing 4.2 dia.
1e	75404153	metal strap
1f	84702212	notched pin 4 dia. x 24
1g	84703112	notched pin 4 dia. x 36
1h	84400112	lock washer 4.1 dia.
1i	84301713	cap nut M4
1k	80201312	special screw 4 dia. x 72
②	75306959	heel plate, complete with struts f.Z.5470
	75307059	heel plate, complete with struts f.Z.5474
2a	75204873	strut for Z.5470
	75209774	strut for Z.5474
2b	84705010	notched pin 2 dia. x 12

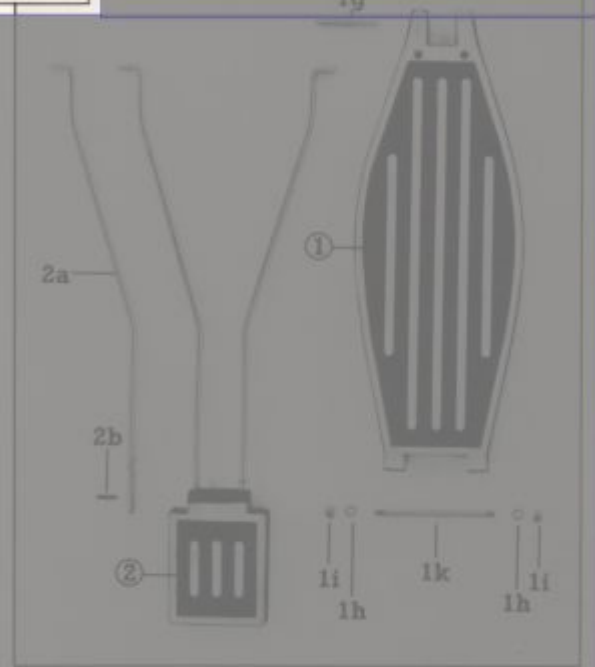

# Signature Series Cymbal Stand HLZ 5280

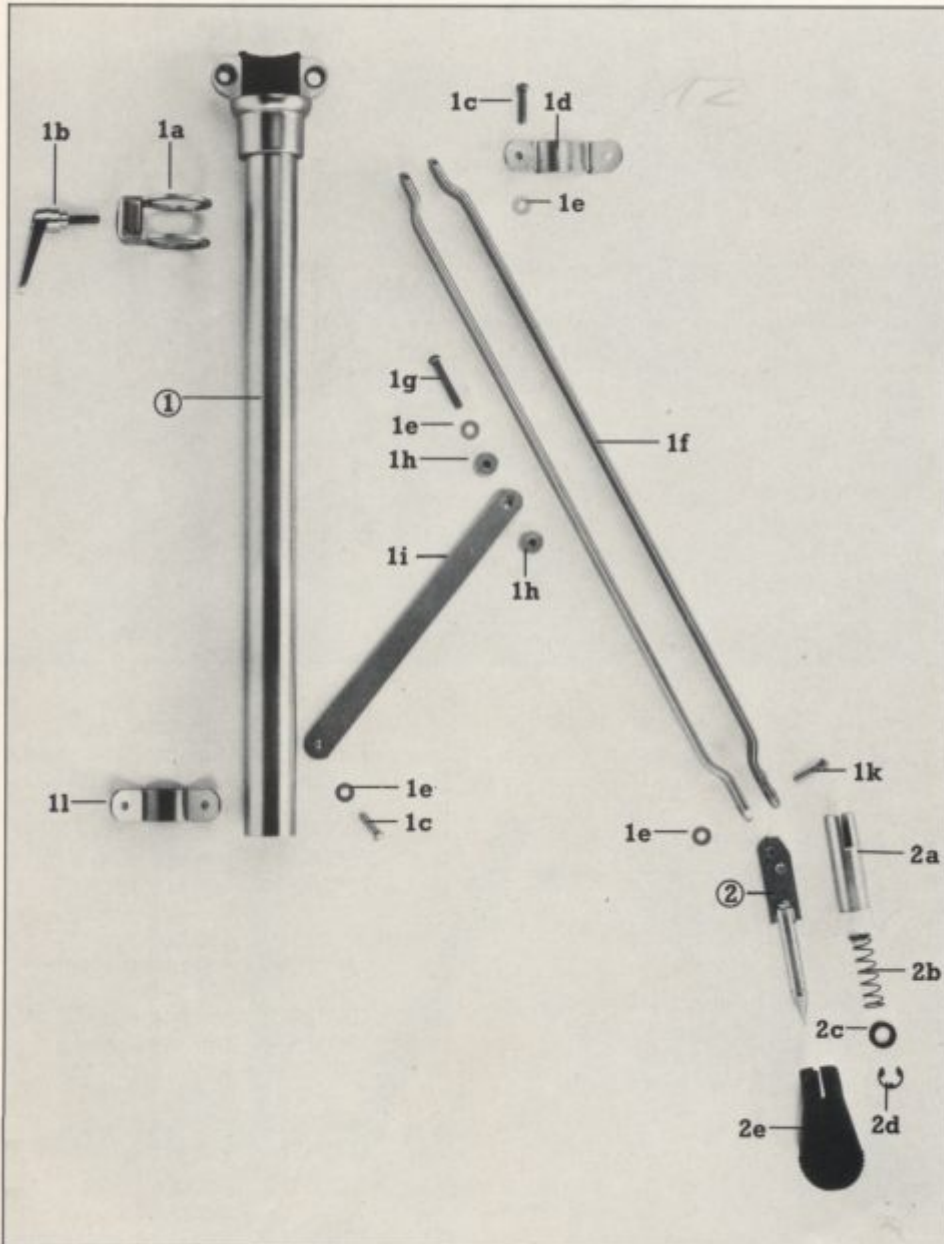
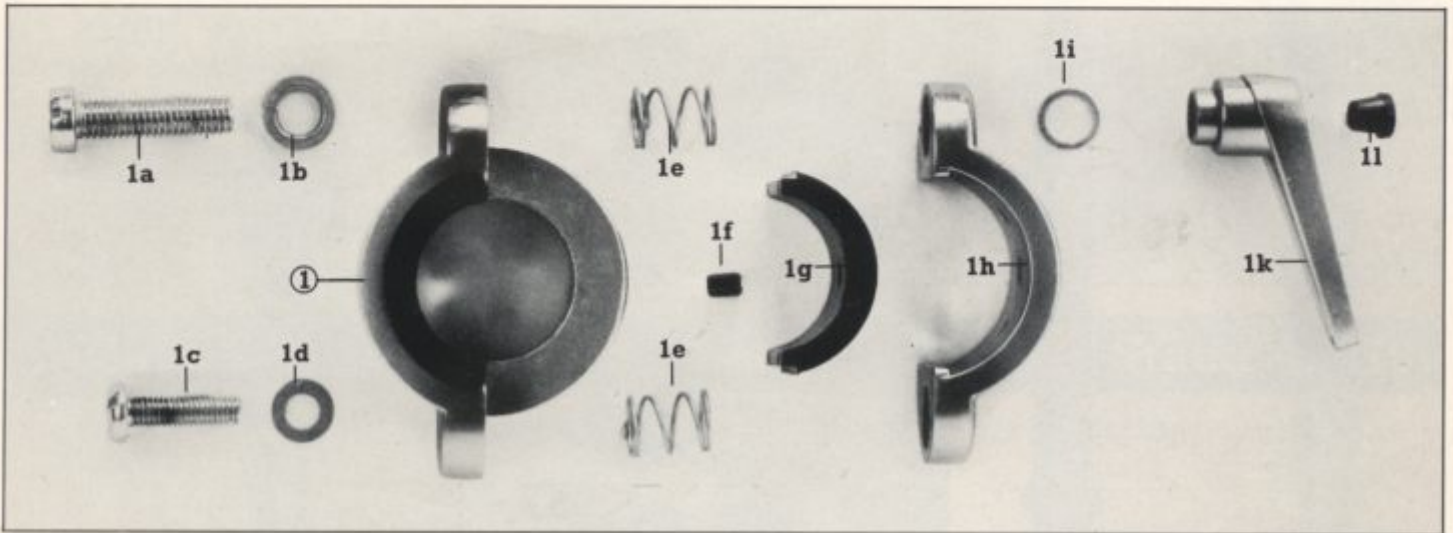

- ① 75000854 clamp 32 dia.
- 1a 84206713 cylinder screw M8x30
- 1b 84400412 lock washer 8.2 dia.
- 1c 84206613 flat headed screw M6x22
- 1d 84500412 washer 6.4 dia.
- 1e 75702210 tension spring 12 dia.
- 1f 84003810 notched bolt 4x8 dia.
- 1g 75809300 clamp bushing 29 dia.
- 1h 75001054 bow 32 dia.
- 1i 84501112 washer 9.3 dia.
- 1k 80205154 lever nut M8
- 1l 75901010 plug

- ① 75106059 tube 32 dia.
- 1a 75208374 clamping device
- 1b 80205554 lever screw M6x20
- 1c 84002610 rivet 5 dia. x21.5
- 1d 75208174 bracket without hole
- 1e 84500112 washer 5.3 dia.
- 1f 75207774 long strut
- 1g 84002810 rivet 5 dia. x33
- 1h 84503213 spacer
- 1i 75207874 short strut
- 1k 84003510 rivet 5 dia. x19.5
- 1l 75208074 bracket with hole
- ② 75208474 strut
- 2a 75509554 tube
- 2b 75704610 tension spring 10.5 dia.
- 2c 75809500 washer
- 2d 84503310 disc
- 2e 75809600 rubber foot

# Signature Series Cymbal Stand Z 5280

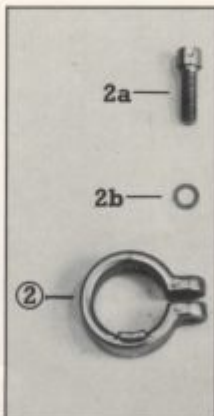
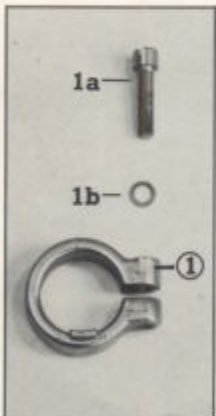
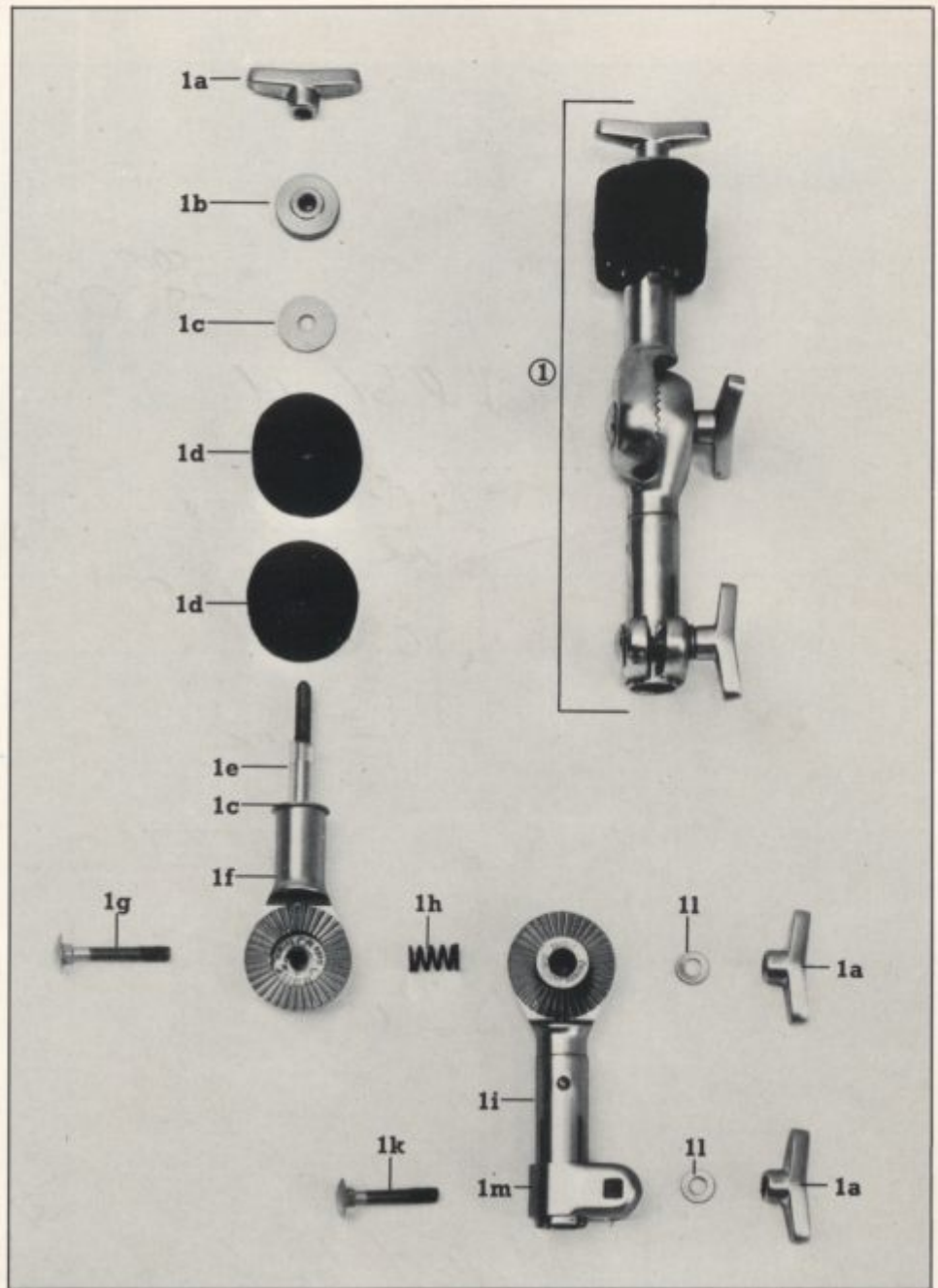
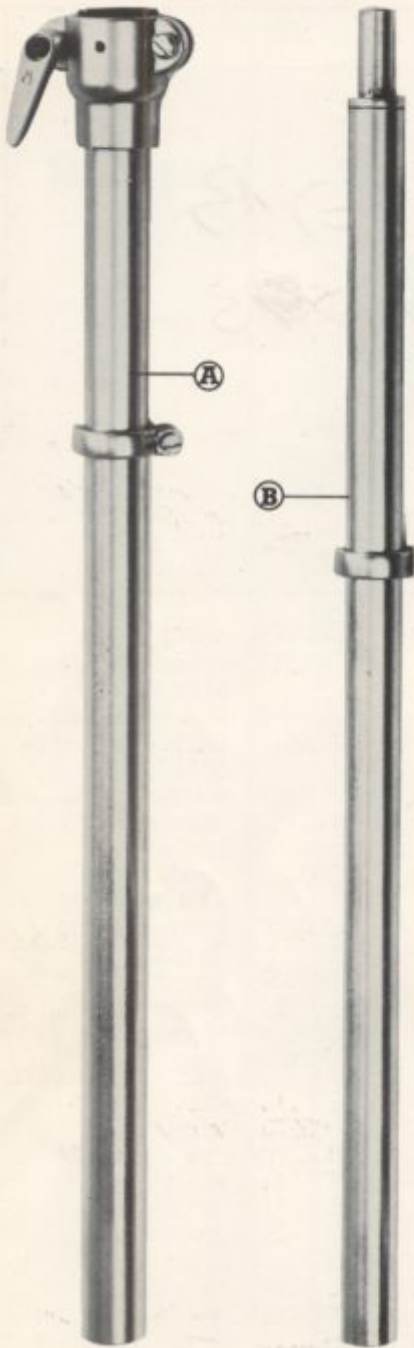

- ① 75001354 fix clamp 29 dia.
- 1a 80200253 slotted screw M6 x 25
- 1b 84500512 washer 6.5 dia.
- ② 75001454 fix clamp 26 dia.
- 2a 80200353 slotted screw M6 x 20
- 2b 84500512 washer 6.5 dia.

- ① 11600501 cymbal tilter, complete Z 5221
- 1a 80205254 wing nut M6, small
- 1b 84303054 knurled nut, M6 flat
- 1c 84500912 washer 6.5 dia.
- 1d 75801410 felt washer 10 dia.
- 1e 75805351 rubber hose 6 dia.
- 1f 75408554 top ratchet with threaded bolt M6 x 30
- 1g 84200854 flat round screw M6 x 40
- 1h 75701910 tension spring
- 1i 75001574 ratchet 19.5 dia.
- 1k 84200654 flat round screw M6 x 35
- 1l 84500412 washer 6.4 dia.
- 1m 75204754 clamping device
- Ⓐ 75106159 middle tube, complete
- Ⓑ 75106359 top tube, complete



## Signature Series Cymbal Stand Z 5280

- ① 75000954 clamp 29 dia.
- 1a 84206713 cylinder screw M 8x30
- 1b 84400412 lock washer 8.2 dia.
- 1c 84206613 flat headed screw M 6x22
- 1d 84500412 washer 6.4 dia.
- 1e 75702210 tension spring 12 dia.
- 1f 84003810 notched bolt 4x8 dia.
- 1g 75809400 clamp bushing 26 dia.
- 1h 75001154 bow 29 dia.
- 1i 84501112 washer 9.3 dia.
- 1k 80205154 lever nut M 8
- 1l 75901010 plug

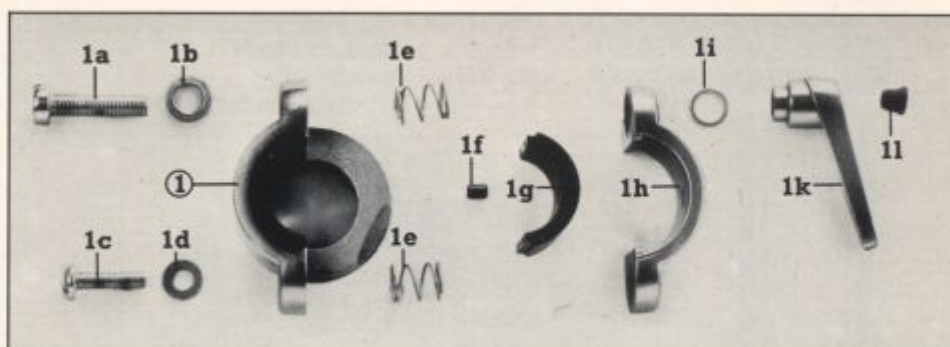

## Phonic Plus Cymbal Stand Z 5270

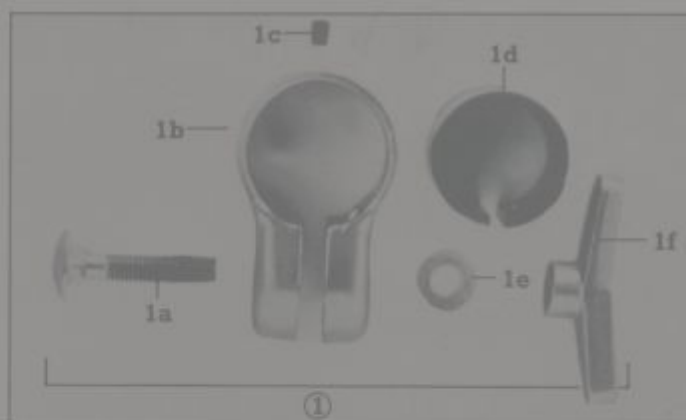

- ① 75008789 clamping device, complete
- 1a 84207553 flat round screw M 8x45
- 1b 75006753 clamping device 37 dia.
- 1c 84004210 notched pin
- 1d 75901800 clamp bushing 29 dia.
- 1e 84500712 washer 8.4 dia.
- 1f 80206883 wing nut M 8

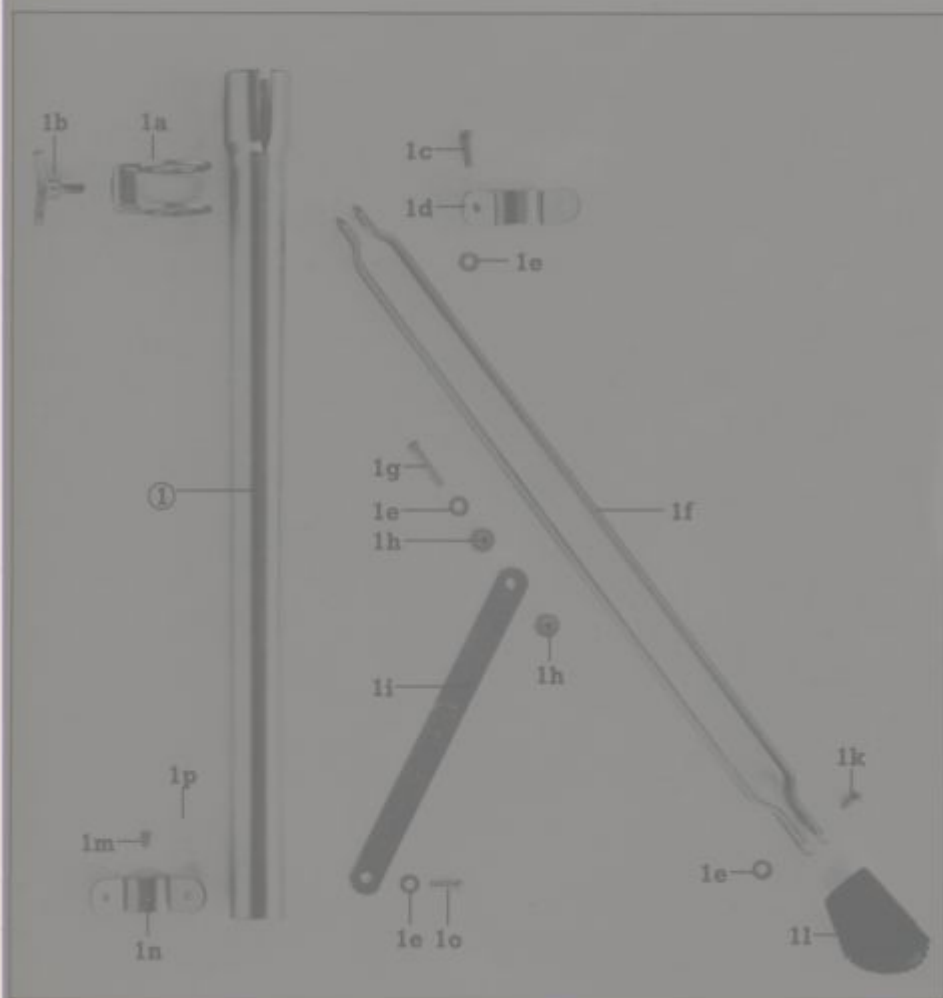

- ① 75107653 bottom tube 32 dia.
- 1a 75208373 clamping device 32.5 dia.
- 1b 80206953 wing screw M 6x25
- 1c 84004410 rivet 5 dia. x 18
- 1d 75208173 bracket without hole
- 1e 84500112 washer 5.3 dia.
- 1f 75005873 long strut
- 1g 84004510 rivet 5 dia. x 28
- 1h 84503213 spacer
- 1i 75006073 short strut
- 1j 84004310 rivet 5 dia. x 11
- 1k 75902000 rubber leg
- 1l 84002910 rivet 4 dia.
- 1m 75208073 bracket with hole
- 1n 84002710 rivet 5 dia. x 16.5
- 1o 84503410 washer 4.3 dia.
- 1p 75207973 bracket without hole (not illustr.)

## Phonic Plus Cymbal Stand Z 5270



- ① 75107853 top tube  
26 dia. x 1.2 x 650
- ② 75107753 middle tube  
26 dia. x 1.2 x 595



- ① 75005859 clamping device, complete
- 1a 84207553 flat round screw  
M 8 x 45
- 1b 75008853 clamping device  
34 dia.
- 1c 84004210 notched pin 4 dia.
- 1d 75901900 clamp bushing  
26 dia.
- 1e 84500712 washer 8.4 dia.
- 1f 80206853 wing nut M 8
- ① 75408553 top ratchet
- 1a 80205253 wing nut M 6
- 1b 84303053 knurled nut M 6
- 1c 84500912 washer 6.5 dia.
- 1d 75801410 felt washer 10 dia.
- 1e 75808351 rubber hose 6 dia.
- 1f 84200853 flat round screw  
M 6 x 40
- 1g 75701910 tension spring  
10 dia.
- 1h 84500412 washer 6.4 dia.

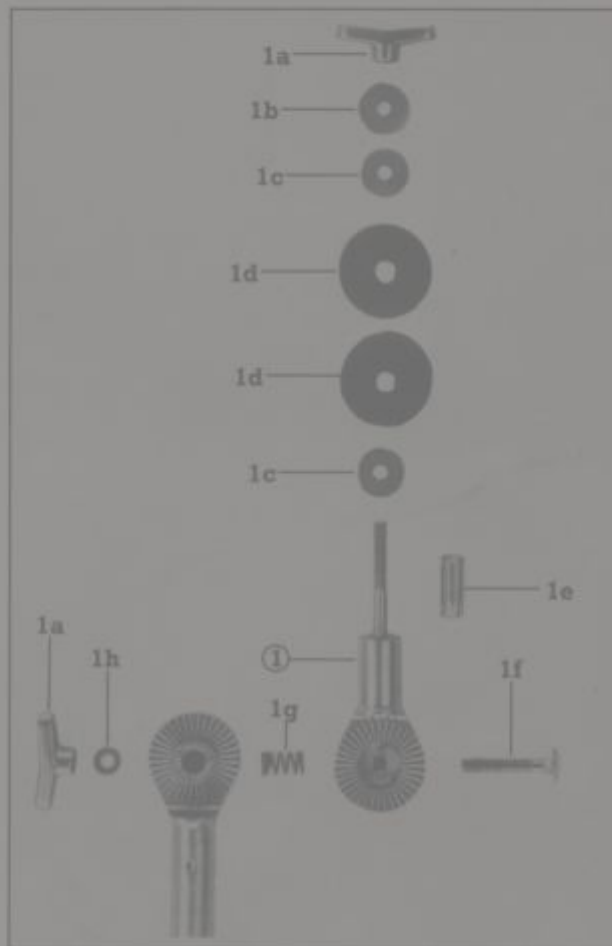

## Cymbal Boom Arm Z 5273

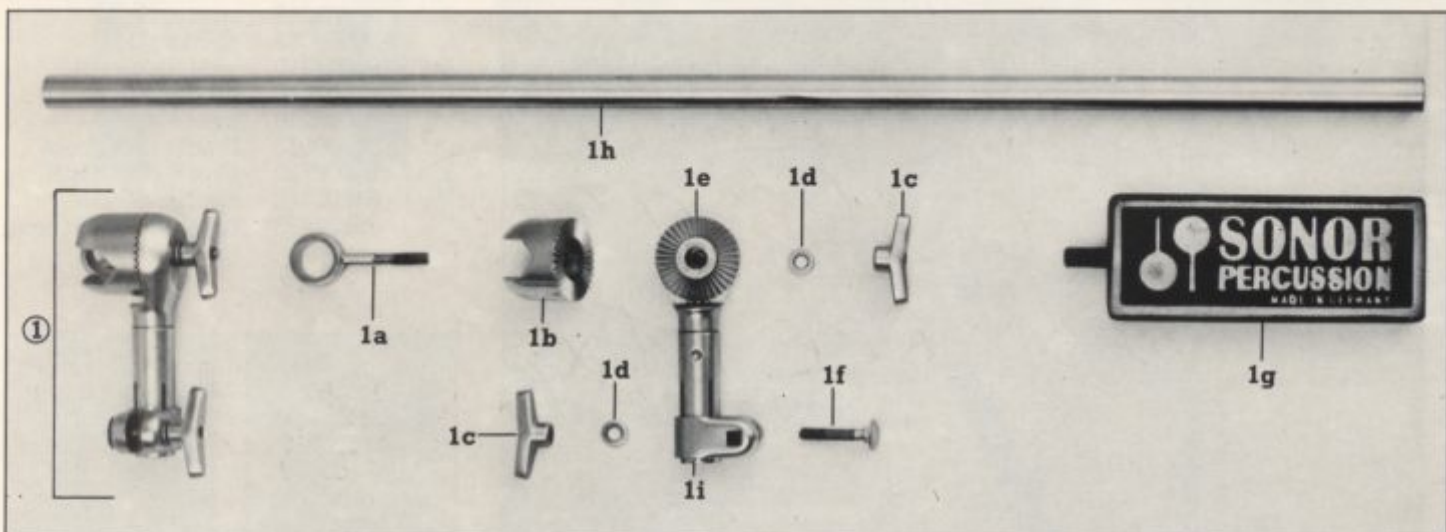

- ① 75409459 tilter, complete
- 1a 80204754 screw  
M 6 x 52
- 1b 75409454 tilter
- 1c 80205254 wing nut M 6
- 1d 84500412 washer 6.4 dia.
- 1e 75001574 ratchet 19.5 dia.
- 1f 84200654 flat round screw  
M 6 x 35
- 1g 75409855 counter weight  
tube 16.5 dia.
- 1h 75105874 tube 16.5 dia.
- 1i 75204754 clamping device  
19.5 dia.

# Double Cymbal Stand Z 5278

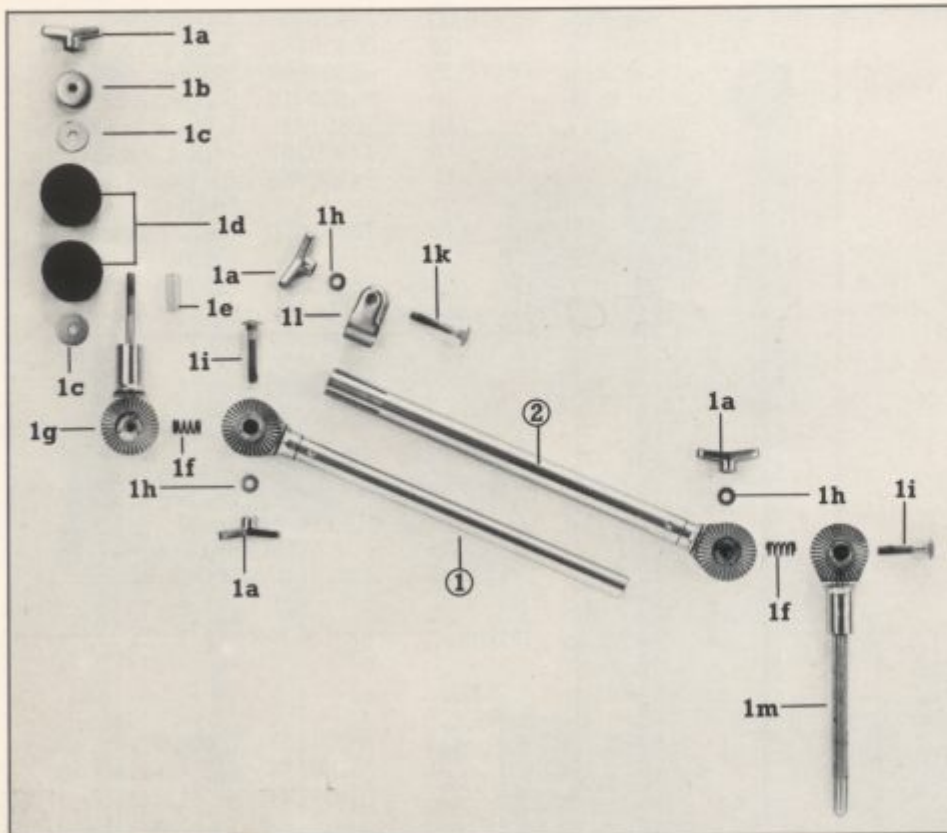

- ① 75104073 top tube with ratchet
- 1a 80205254 wing nut M6
- 1b 84303053 knurled nut M6
- 1c 84500912 washer 6.5 dia.
- 1d 75801410 felt washer 10 dia.
- 1e 75805351 rubber hose 6 dia.
- 1f 75701910 tension spring 10 dia.
- 1g 75408553 cymbal tilter with threaded bolt
- 1h 84500412 washer 6.4 dia.
- 1i 84200854 flat round screw M 6 x 40
- 1k 84200654 flat round screw M6 x 35
- 1l 75204754 clamping device 19.5 dia.
- 1m 75601773 ratched
- ② 75103973 bottom tube with ratchet

- ① 75604653 mounting plate
- 1a 75704212 tension spring 11 dia.
- 1b 75605254 mounting bracket 29 dia.
- 1c 80204953 lever nut M6GN100
- 1d 84500412 washer 6.4 dia.
- 1e 84202012 cylinder screw M6 x 40
- 1f 84400312 lock washer 6.1 dia.
- 1g 84301513 cap nut M6

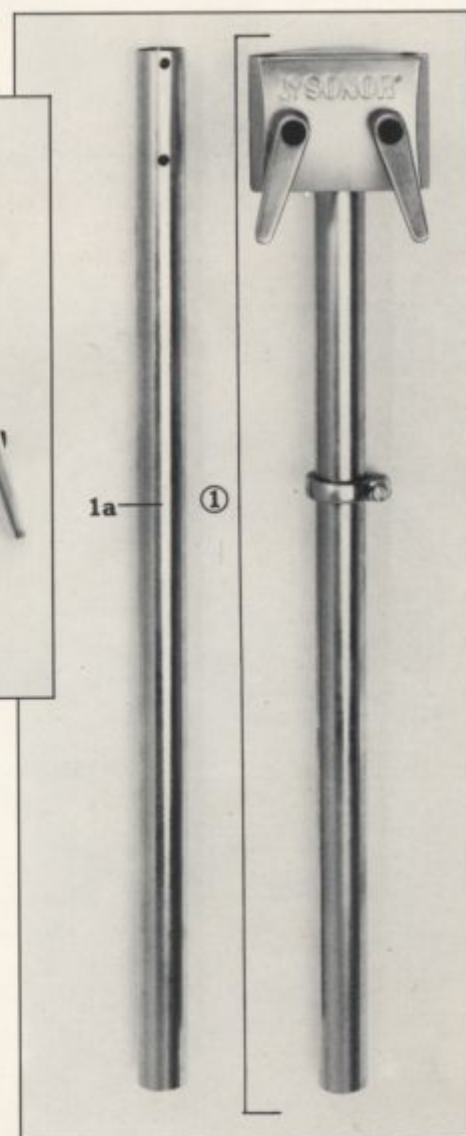
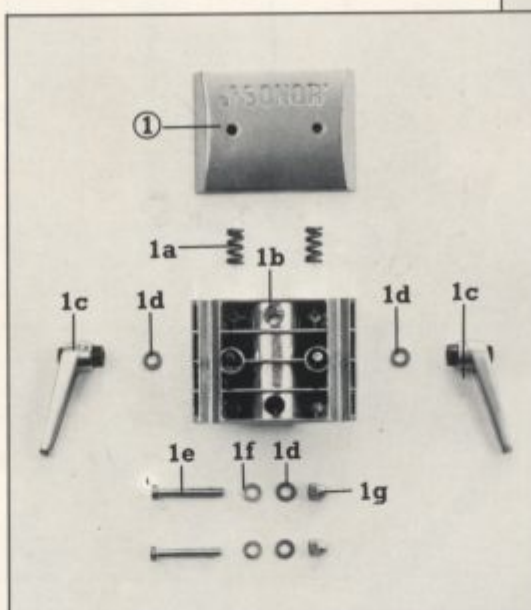

Base see Z 5270 on page 23.

- ① 75106259 tube with tom tom holder (without fix clamp)
- 1a 75106254 tube 29 dia.

# Signature Series Double Tom Stand HLZ 5285

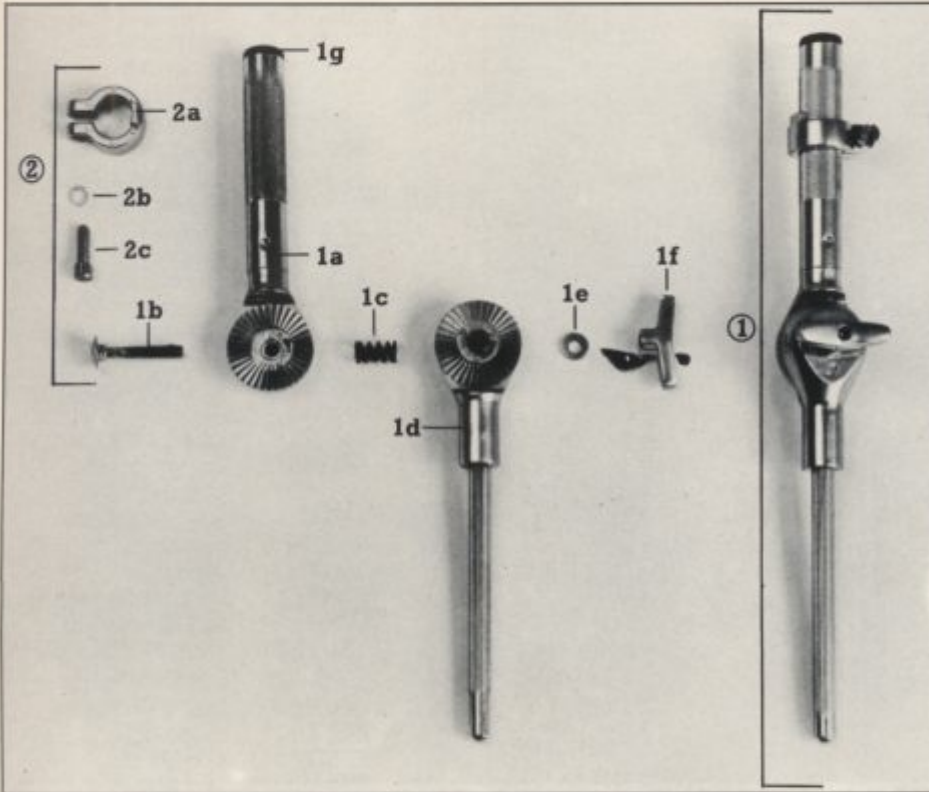

- ① 11606101 tom tom arm Z 5508 c
- 1a 75601873 tom tom arm with ratchet
- 1b 84200854 flat round screw M 6 x 40
- 1c 75701910 tension spring 10 dia.
- 1d 75601773 ratchet 10 dia.
- 1e 84500412 washer 6.4 dia.
- 1f 80205254 wing nut M 6
- ② 75003854 fix clamp, right without screw
- 75003859 fix clamp, right, complete
- 1g 75809210 plug A 170
- ② 75003959 fix clamp, complete
- 2a 75003954 fix clamp, without screw
- 2b 84500512 washer 6.5 dia.
- 2c 80200353 slotted screw M6 x 20

- ① 75604653 mounting plate
- 1a 75704212 tension spring 11 dia.
- 1b 75605254 mounting bracket 29 dia.
- 1c 80204953 lever nut M 6 GN100
- 1d 84500412 washer 6.4 dia.
- 1e 84202012 cylinder screw M6 x 40
- 1f 84400312 lock washer 6.1 dia.
- 1g 84301513 cap nut M6

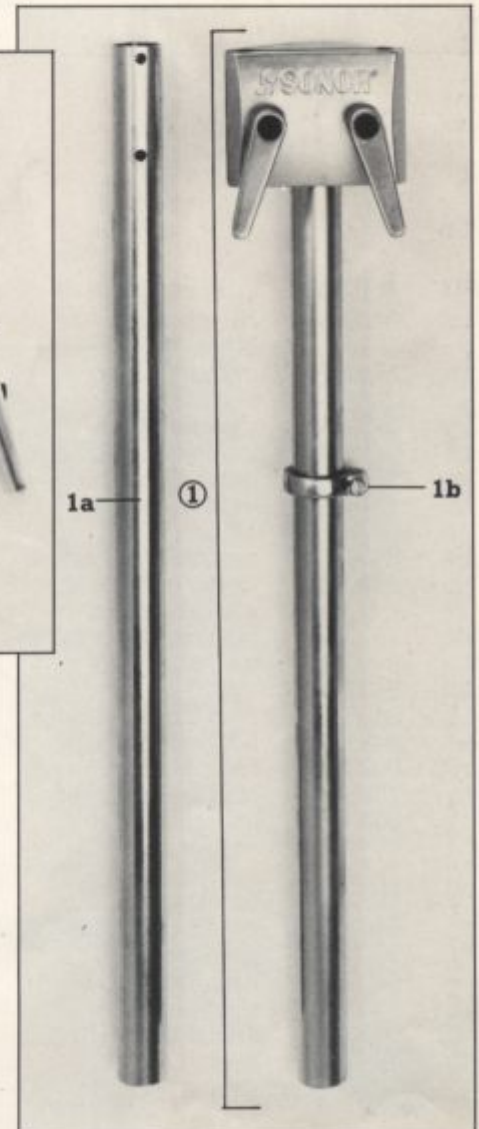
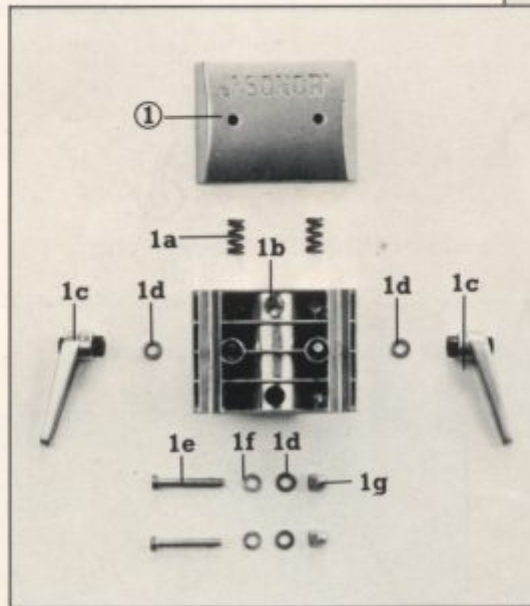

Base see HLZ 5280 on page 21.

Phonic Plus Double Tom stand without fix-clamp. For base see Z 5270 on page 24

- ① 75106259 tube with tom tom holder
- 1a 75106254 tube 29 dia.
- 1b 75001359 fix clamp 29 dia., complete

# Signature Series Snare Drum Stand HLZ 5580

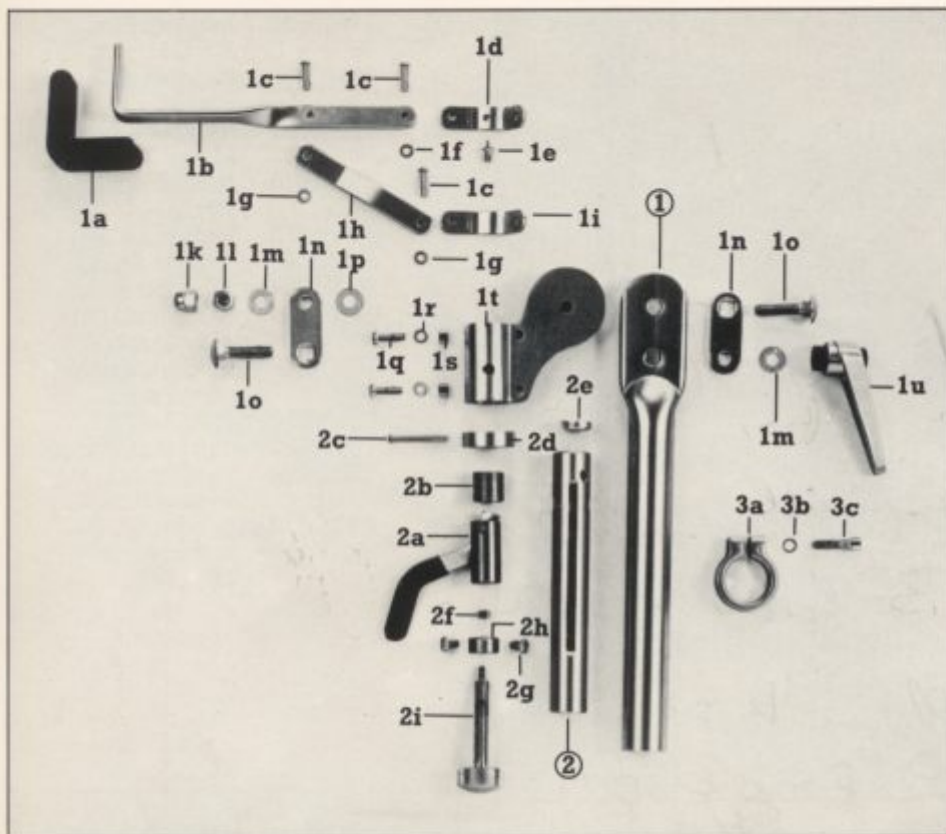

- ① 75106654 tube 29 dia.
- 1a 75809700 rubber sleeve
- 1b 75209174 holder arm
- 1c 84709310 rivet 4 dia.x 16.5
- 1d 75205274 bracket with hole
- 1e 84703312 blind rivet 4 dia.
- 1f 84502412 washer 4.3 dia.
- 1g 84500312 washer 4.3 dia.
- 1h 75209274 strut
- 1i 75205074 bracket without hole
- 1k 84304913 cap nut M 8
- 1l 84300610 hex nut M 8
- 1m 84500712 washer 8.4 dia.
- 1n 75207174 clamp strap
- 1o 84205854 flat round screw M 8x35
- 1p 84502710 washer 8.4 dia.
- 1q 84105813 flat top screw M 5x18
- 1r 84500112 washer 5.3 dia.
- 1s 84301913 cap nut M 5
- 1t 75005474 clamp
- 1u 80205454 lever nut 22xM 8 GN 100
- ② 75106874 tube 24 dia.x2x165
- 2a 75209379 lever assembly
- 2b 75501900 bolt 19.5 dia.
- 2c 84700112 rivet 4 dia.
- 2d 75502354 ring 34 dia.
- 2e 75404502 cap 20 dia.
- 2f 84301713 cap nut M4
- 2g 84102012 liko screw M5 x 8
- 2h 75502000 tension nut
- 2i 80205354 knurled screw M 10x75/93

- ① 75106559 tube, complete
- 1a 84206613 flat top screw M6 x 22
- 1b 84206713 cylinder screw M8 x 30
- 1c 84500412 washer 6.4 dia.
- 1d 84400412 lock washer 8.2 dia.
- 1e 75001059 bracket, complete
- 1f 75702210 tension spring 12 dia.
- 1g 84003810 tension bolt 4 dia.x8
- 1h 75809300 clamp cup 29 dia.
- 1i 84500112 washer 5.3 dia.
- 1k 75208274 bracket with hole
- 1l 84503410 washer 4.3 dia.
- 1m 84002910 rivet 4 dia.x8
- 1n 84002610 rivet 5 dia.x21.5
- 1o 84501112 washer 9.3 dia.
- 1p 80205154 lever nut M 8
- 1q 75901010 plug for lever nut
- 1r 80205159 lever nut M 8 with plug
- 1s 75208674 long strut
- 1t 75208074 bracket with hole
- 1u 84004810 rivet 5 dia.x 15.5
- 1v 75005574 short strut
- 1w 84003910 rivet 5 dia. x 12
- 1x 75005674 short strut
- 1y 84003510 rivet 5 dia. x 19.5
- ② 75208474 strut
- 2a 75509554 tube

- 2b 75704610 tension spring 10.5 dia.
- 2c 75809500 washer 10.1 dia.
- 2d 84503310 disc
- 2e 75809600 rubber foot

- ③ 75001354 fix clamp 29 dia.
- 3a 84500512 washer 6.5 dia.
- 3c 80200353 slotted screw M 6x20

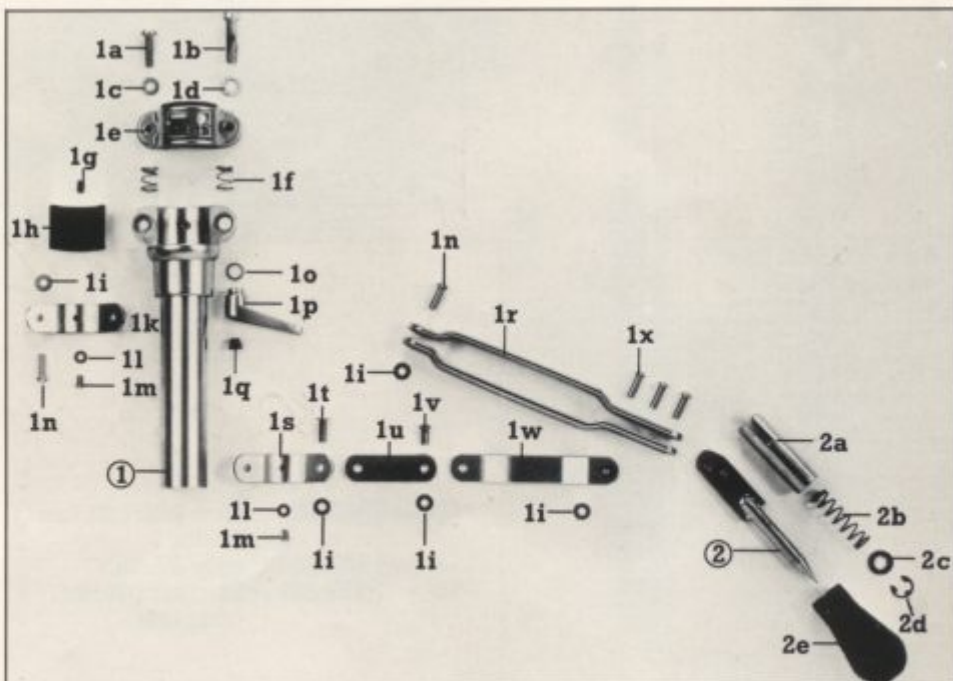

# Tom Tom Holders, Extension tube

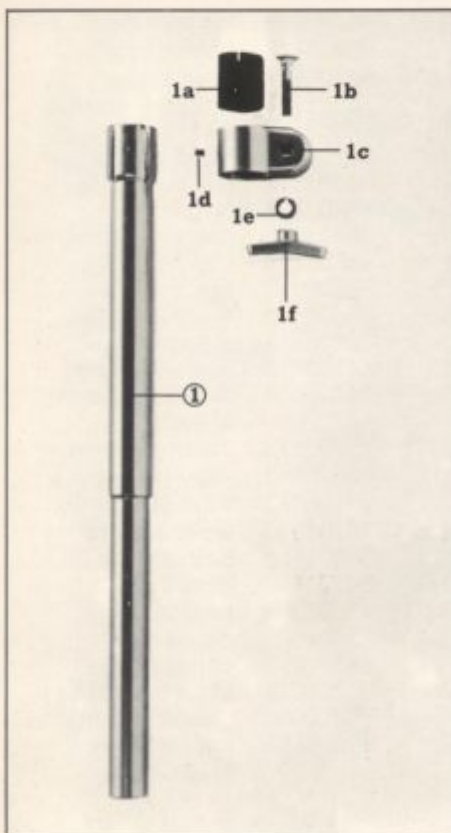

- ① 75108173 extension tube 32 dia.
- 1a 75901800 clamp bushing 29 dia.
- 1b 84207553 flat round screw M8x45
- 1c 75005753 clamp 37 dia.
- 1d 84004210 notched pin 4 dia.
- 1e 84500712 washer 8.4 dia.
- 1f 80206853 wing nut M8

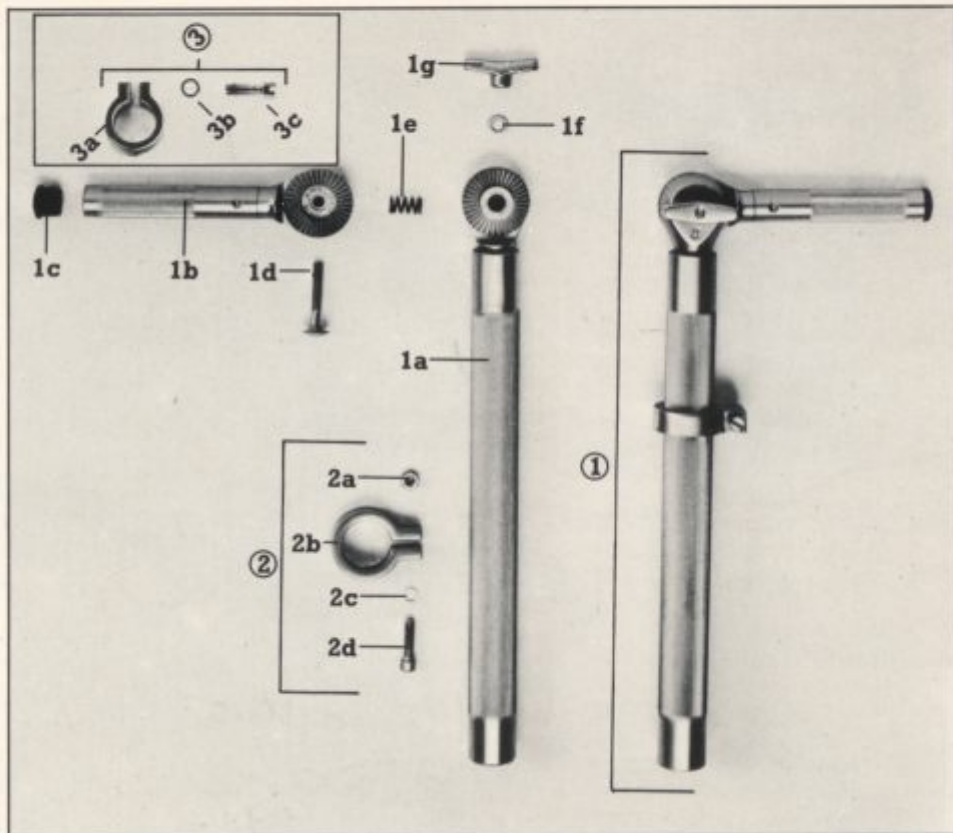

- ① 11603401 single tom tom holder, complete Z 5511b bottom tube 28 dia. with ratchet
- 1a 75604973 tom tom arm with ratchet
- 1b 75601873 plug A170
- 1c 75809210 flat round screw M6 x 40
- 1d 84200854 tension spring
- 1e 75701910

- 1f 84500412 washer 6.4 dia.
- 1g 80205254 wing nut M6
- ② 75604359 fix clamp 28 dia. complete
- 2a 84300512 hex nut M6
- 2b 75604354 fix clamp 28 dia. without screw
- 2c 84500512 washer 6.5 dia.
- 2d 80200253 slotted screw M6 x 25

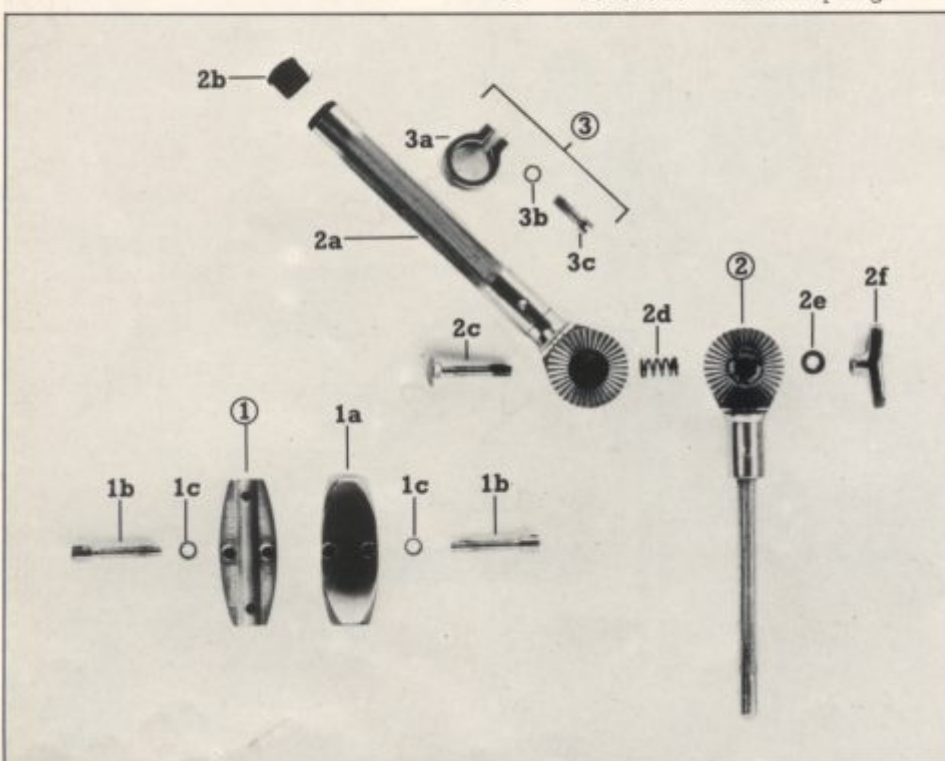

- ① 74102053 prism lug, bottom
- 1a 74101154 prism lug, top
- 1b 80100153 slotted screw 1/4" x 35
- 1c 84500512 washer 6.5 dia.
- ② 75601773 ratchet
- 2a 75601873 ratchet
- 2b 75809210 plug A 170
- 2c 84200854 flat round screw M 6 x 40
- 2d 75701910 tension spring 10 dia.
- 2e 84500412 washer 6.4 dia.
- 2f 80205254 wing nut M 6
- ③ 75003959 fix clamp 19 dia., left, complete
- 3a 75003954 fix clamp, left (without screw)
- 3b 84500512 washer 6.5 dia.
- 3c 80200353 slotted screw M 6 x 20

# Tom Tom Holders

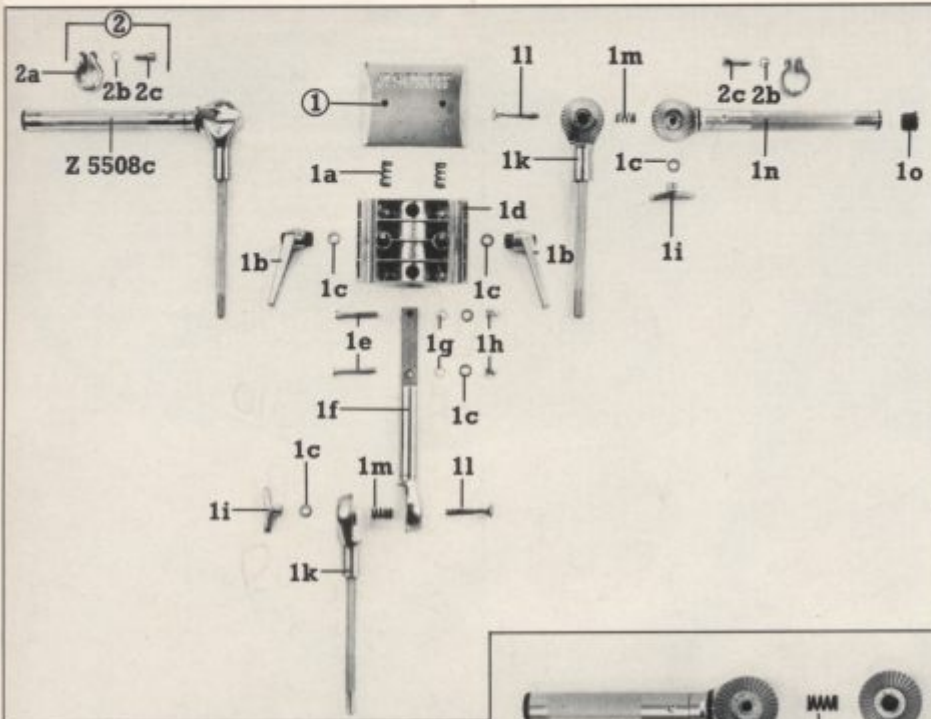

## Z 5518b

- ① 75604653 mounting plate
- 1a 75704212 tension spring  
11 dia.
- 1b 80204953 lever nut  
M6GN100
- 1c 84500412 washer 6.4 dia.
- 1d 75604553 mounting bracket  
19.5 dia.
- 1e 84206312 cylinder screw  
M6 x 35
- 1f 75605173 tom tom arm with  
ratchet
- 1g 84400312 lock washer 6.1 dia.
- 1h 84301513 cap nut M6
- 1i 80205254 wing nut M6
- 1k 75601773 ratchet
- 1l 84200854 flat round screw  
M6 x 40
- 1m 75701910 tension spring  
10 dia.
- 1n 75601873 tom rom arm with  
ratchet

- ② 75003959 fix clamp, complete
- 2a 75003954 fix clamp,  
(without screw)
- 2b 84500512 washer 6.5 dia.
- 2c 80200353 slotted screw  
M6 x 20

## Z 5513b

- ① 75604653 mounting plate
- 1a 75601873 tom rom arm with  
ratchet
- 1b 84200854 flat round screw  
M6 x 40
- 1c 75701910 tension spring  
10 dia.
- 1d 75601773 ratchet
- 1e 84500412 washer 6.4 dia.
- 1f 80205254 wing nut M6
- 1g 75704212 tension spring  
11 dia.
- 1h 75604453 mounting bracket  
28 dia.
- 1i 80204953 lever nut M6GN100
- 1k 84202012 cylinder screw  
M6 x 40
- 1l 84400312 lock washer 6.1 dia.
- 1m 84301513 cap nut M6
- 1n 75605073 bottom tube 28 dia.
- 1o 75809210 plug A170
- ② 75003959 fix clamp, left,  
complete
- 75003859 fix clamp, right,  
complete
- 2a 80200353 slotted screw  
M6 x 20
- 2b 84500512 washer 6.5 dia.
- 2c 75003954 fix clamp, left,  
(without screw)
- ③ 75604359 fix clamp 28 dia.,  
complete
- 3a 84300512 hex nut M6
- 3b 75604354 fix clamp 28 dia.
- 3c 84500512 washer 6.5 dia.
- 3d 80200253 slotted screw M6 x 25

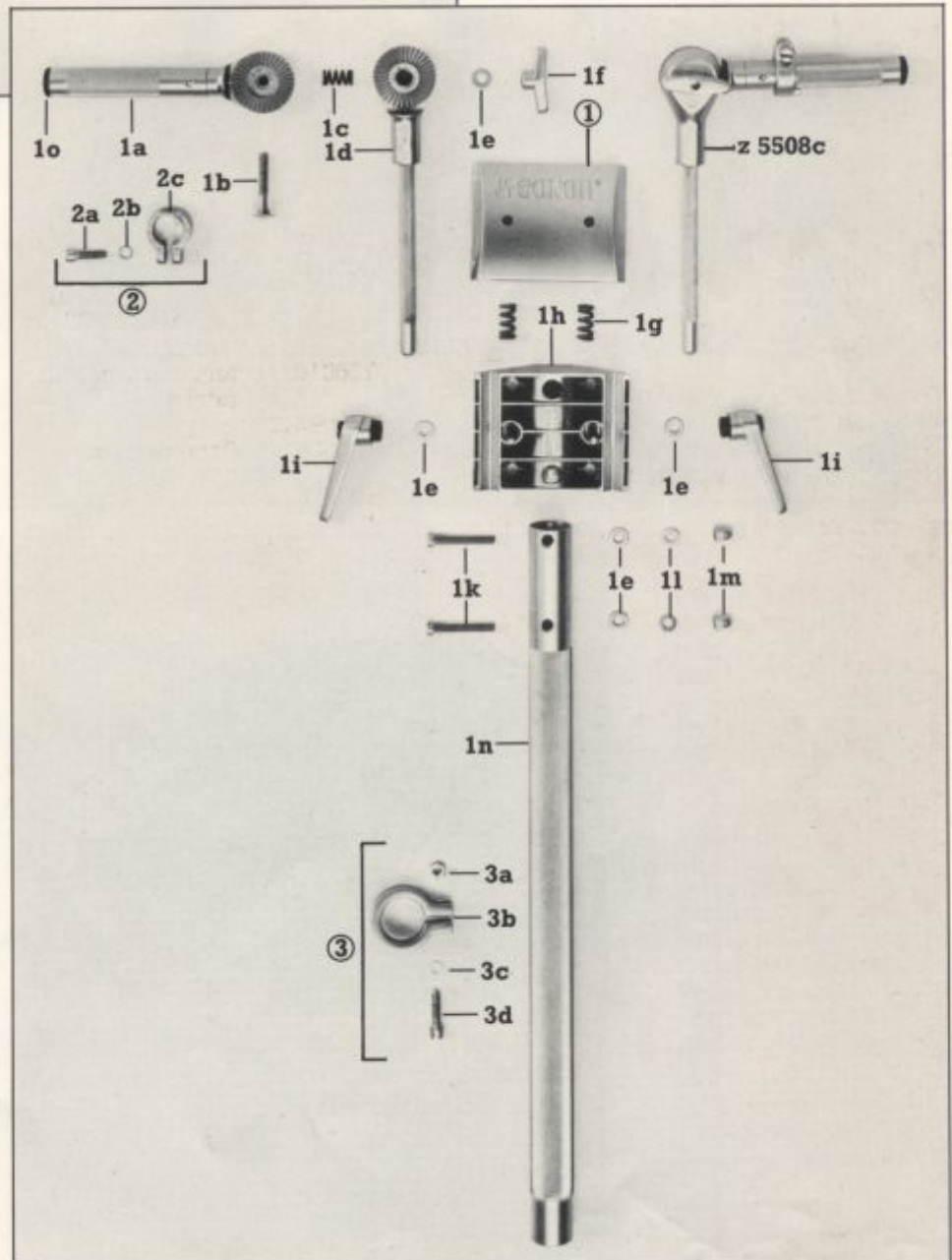

## Signature Series Badges, complete with screws and nuts

- 80605959 badge for stands and bass drum pedal
- 80606059 badge for snare drums and tom toms
- 80606159 badge for bass drums and floor toms

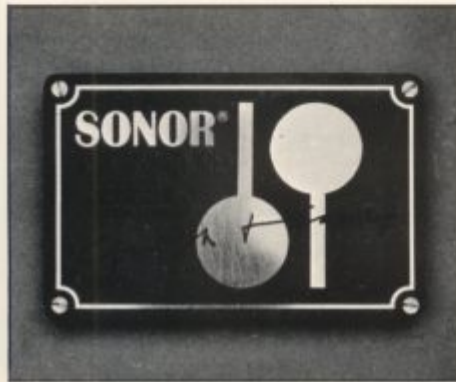

## Phonic/Phonic Plus Badges, complete with rivet

- 80605159 badge "Genuine Rosewood Veneer"
- 80605259 badge "Genuine Oak Veneer"
- 80605359 badge "Genuine Mahogany Veneer"
- 80608459 badge "9 Ply Beechwood Shell"
- 80605559 badge for snare drums
- 80605859 badge "Since 1875"

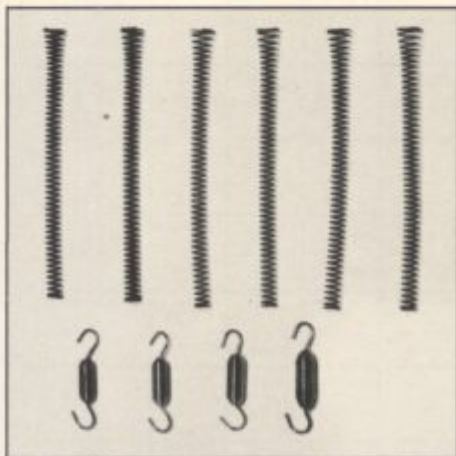

## Hi Hat Tension Springs

- 75705810 Signature Series tension spring 0.8
- 75702510 tension spring 1.00
- 75702410 tension spring 1.10
- 75702610 tension spring 1.05
- 75702910 tension spring 1.15
- 75703010 tension spring 1.20
- 75703110 tension spring 1.25
- 75703210 tension spring 1.30
- 14601101 Z 9500 set of 6 springs, with lubricant
- 14601301 Z 9502 set of 2 springs, with lubricant

## Bass Drum Pedal Tension Springs

- 75700212 tension spring 1.10
- 75700312 tension spring 1.25
- 75700412 tension spring 1.50
- 75700512 tension spring 1.75
- 14601201 Z 9501 set of 3 springs, with drum key

## Spin Key

- 80501354 SONOR spin key

## Bass Felt Strip

- 75806351 felt strip for bass drum, 2 meters

## Snare Cord

- 74704151 snare cord, 2 meters



## Lubricant

- 88401620 lubricant

## SONOR Wood Polish

- 88407200 SONOR wood polish



